

**Project:** Coventry Air Quality  
**Title:** General Layout (Phase A and B)  
**Scale:** 1:2500 at A3  
**Drawn:** PJR  
**Checked:** CS  
**Approved:** GL  
**Status:** CONSULTATION  
**Dwg Ref:** 101130-MMD-00-XX-DR-C-0030

Reproduced from the Ordnance Survey base map with permission of the Controller of Her Majesty's Stationary Office, Crown Copyright  
 Licence No. 100026294, 2021. Unauthorised reproduction infringes Crown Copyright and may lead to prosecution or Civil Proceedings.

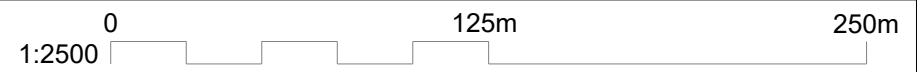



<b>Project:</b>	Coventry Air Quality
<b>Title:</b>	General Layout (Phase C)
<b>Scale:</b>	1:1000 at A3
<b>Drawn:</b>	PJR
<b>Checked:</b>	CS
<b>Approved:</b>	GL
<b>Status:</b>	CONSULTATION
<b>Dwg Ref:</b>	101130-MMD-00-XX-DR-C-0031

Reproduced from the Ordnance Survey base map with permission of the Controller of Her Majesty's Stationary Office, Crown Copyright Licence No. 100026294, 2021. Unauthorised reproduction infringes Crown Copyright and may lead to prosecution or Civil Proceedings.

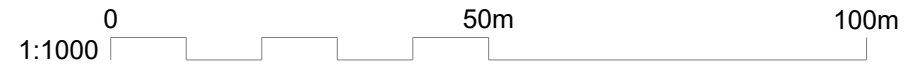

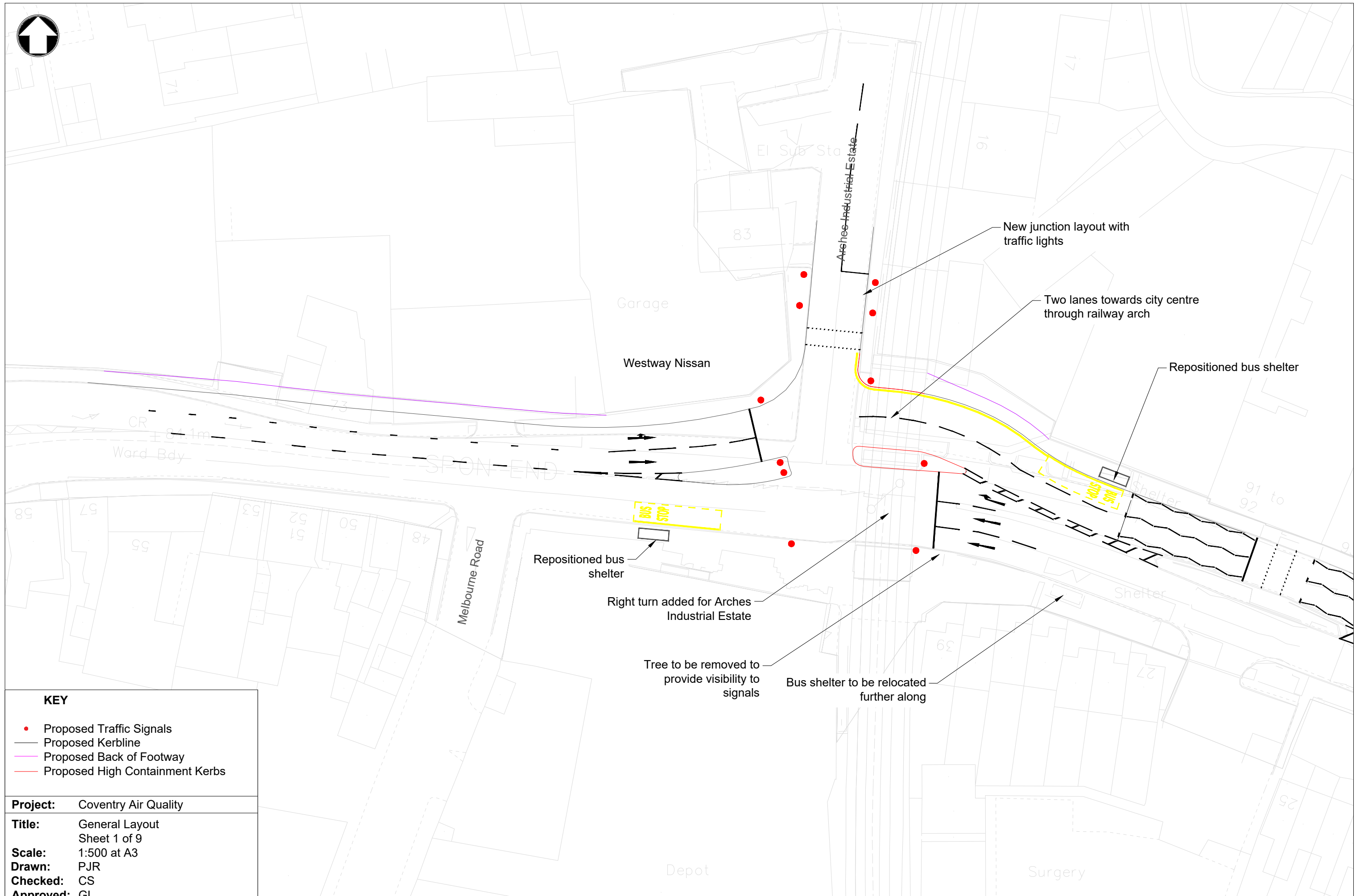

**KEY**

- Proposed Traffic Signals
- Proposed Kerblines
- Proposed Back of Footway
- Proposed High Containment Kerbs

**Project:** Coventry Air Quality

**Title:** General Layout  
Sheet 1 of 9

**Scale:** 1:500 at A3

**Drawn:** PJR

**Checked:** CS

**Approved:** GL

**Status:** CONSULTATION

**Dwg Ref:** 101130-MMD-00-XX-DR-C-0032

Reproduced from the Ordnance Survey base map with permission of the Controller of Her Majesty's Stationary Office, Crown Copyright Licence No. 100026294, 2021. Unauthorised reproduction infringes Crown Copyright and may lead to prosecution or Civil Proceedings.



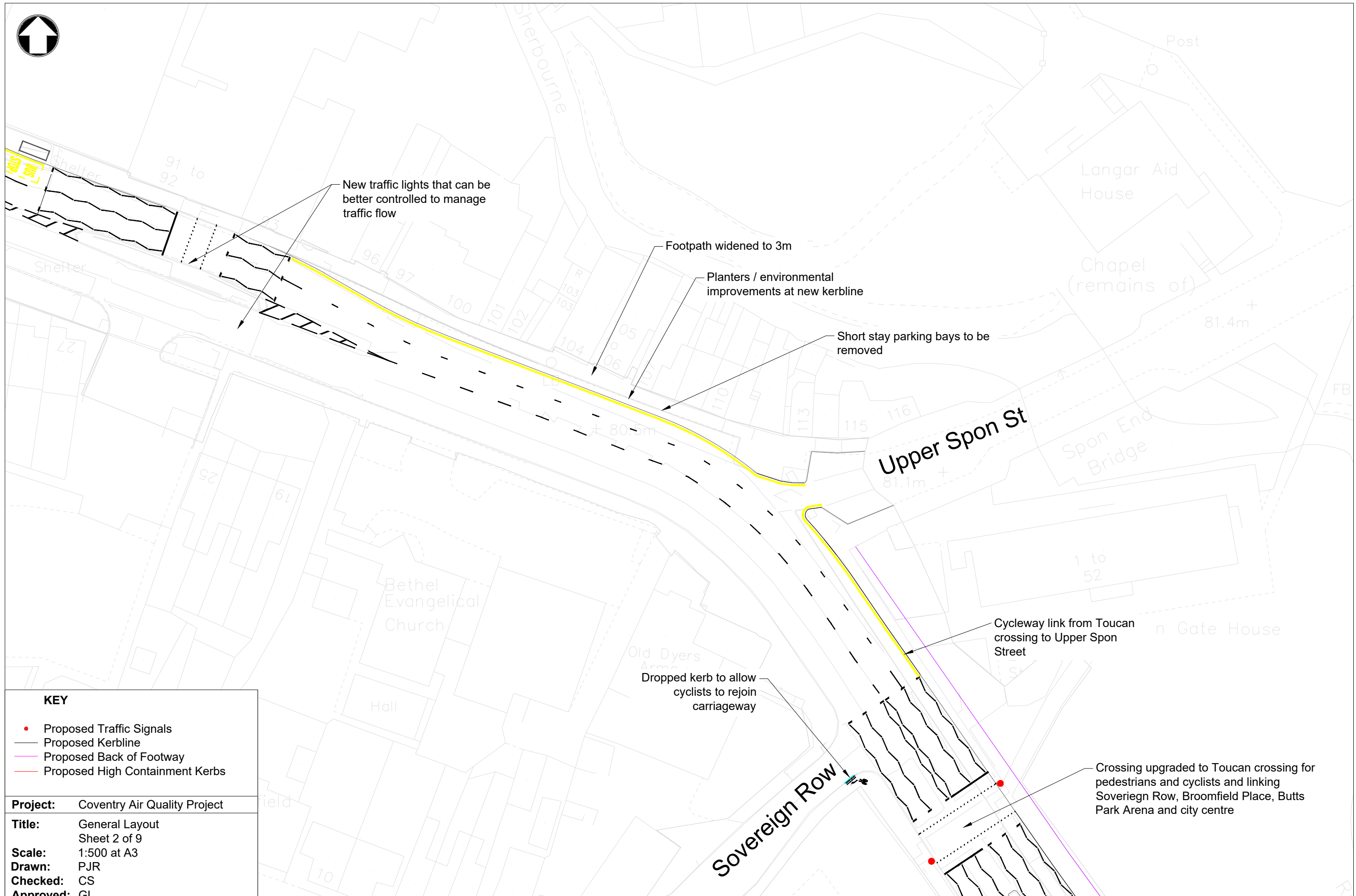

KEY	
•	Proposed Traffic Signals
—	Proposed Kerbline
—	Proposed Back of Footway
—	Proposed High Containment Kerbs
<b>Project:</b>	Coventry Air Quality Project
<b>Title:</b>	General Layout Sheet 2 of 9
<b>Scale:</b>	1:500 at A3
<b>Drawn:</b>	PJR
<b>Checked:</b>	CS
<b>Approved:</b>	GL
<b>Status:</b>	CONSULTATION
<b>Dwg Ref:</b>	101130-MMD-00-XX-DR-C-0033

Reproduced from the Ordnance Survey base map with permission of the Controller of Her Majesty's Stationary Office, Crown Copyright Licence No. 100026294, 2021. Unauthorised reproduction infringes Crown Copyright and may lead to prosecution or Civil Proceedings.

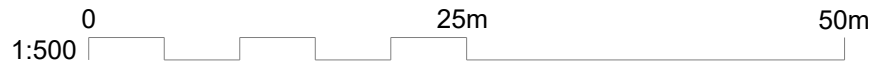

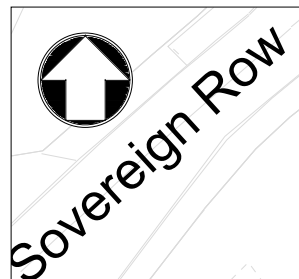
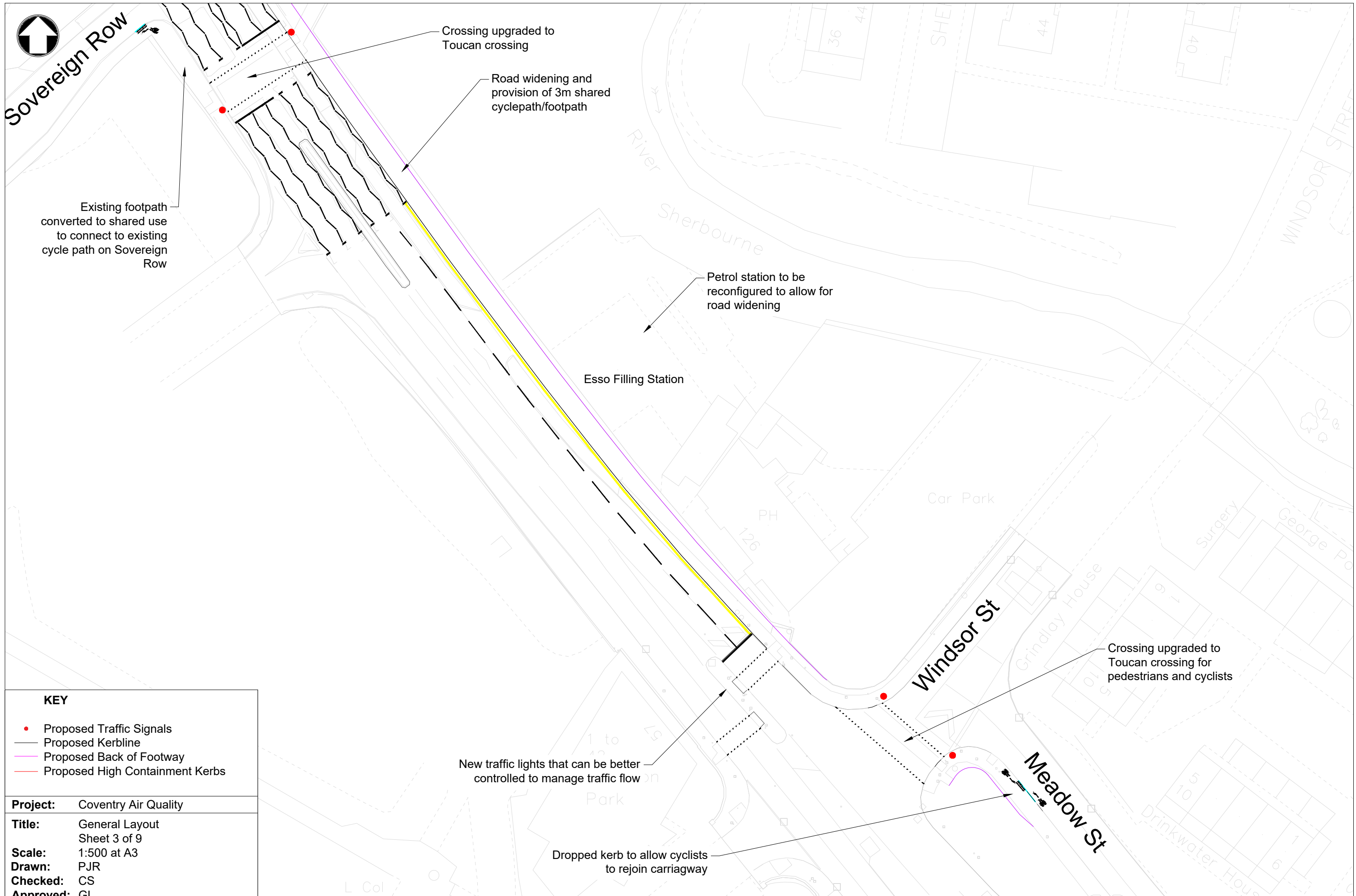

Existing footpath converted to shared use to connect to existing cycle path on Sovereign Row

Crossing upgraded to Toucan crossing

Road widening and provision of 3m shared cyclepath/footpath

Petrol station to be reconfigured to allow for road widening

Esso Filling Station

Windsor St

Meadow St

Crossing upgraded to Toucan crossing for pedestrians and cyclists

New traffic lights that can be better controlled to manage traffic flow

Dropped kerb to allow cyclists to rejoin carriageway

KEY	
•	Proposed Traffic Signals
—	Proposed Kerblines
—	Proposed Back of Footway
—	Proposed High Containment Kerbs

<b>Project:</b>	Coventry Air Quality
<b>Title:</b>	General Layout Sheet 3 of 9
<b>Scale:</b>	1:500 at A3
<b>Drawn:</b>	PJR
<b>Checked:</b>	CS
<b>Approved:</b>	GL
<b>Status:</b>	CONSULTATION
<b>Dwg Ref:</b>	101130-MMD-00-XX-DR-C-0034

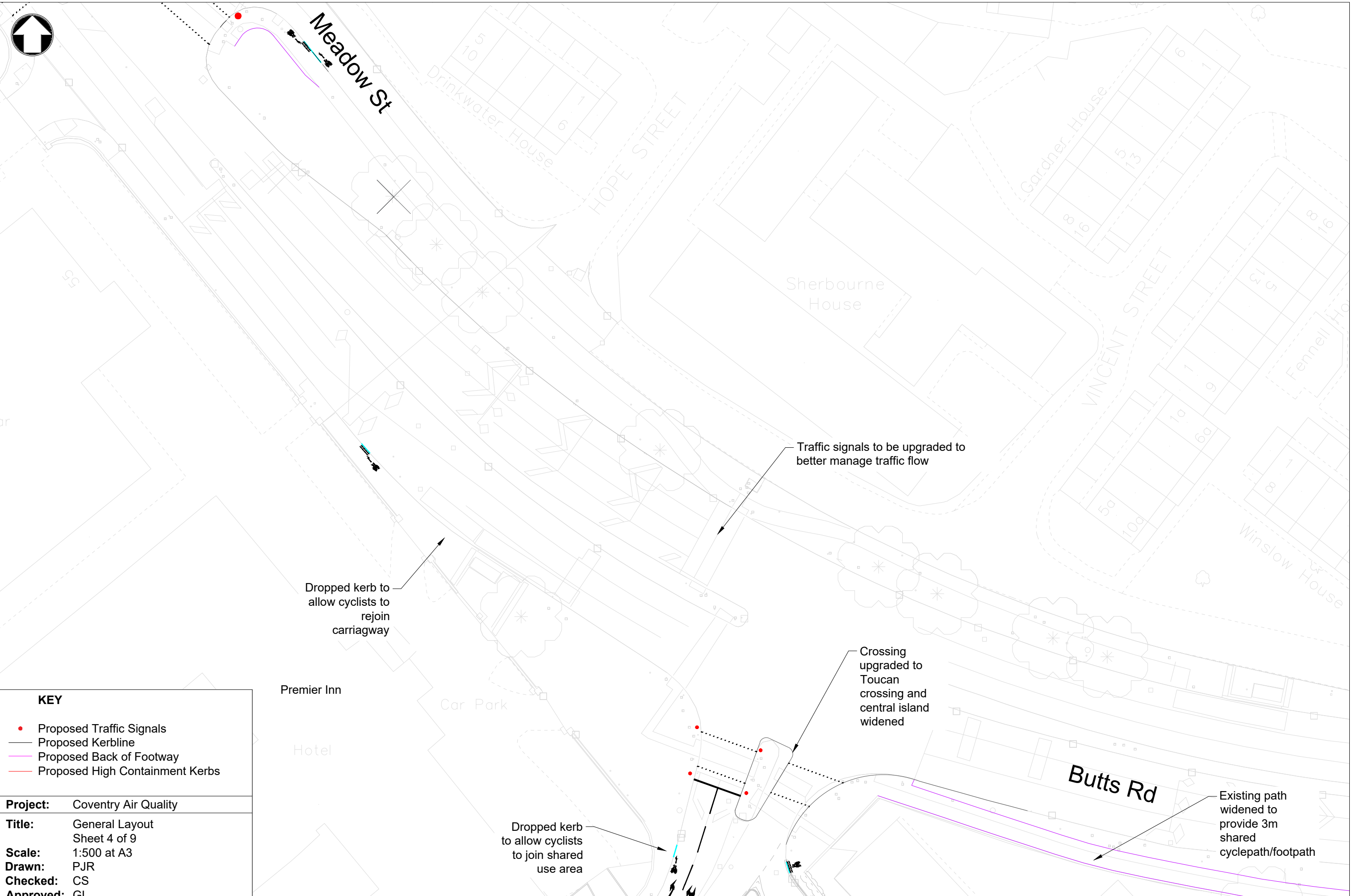

KEY	
•	Proposed Traffic Signals
—	Proposed Kerblines
—	Proposed Back of Footway
—	Proposed High Containment Kerbs

<b>Project:</b>	Coventry Air Quality
<b>Title:</b>	General Layout Sheet 4 of 9
<b>Scale:</b>	1:500 at A3
<b>Drawn:</b>	PJR
<b>Checked:</b>	CS
<b>Approved:</b>	GL
<b>Status:</b>	CONSULTATION
<b>Dwg Ref:</b>	101130-MMD-00-XX-DR-C-0035

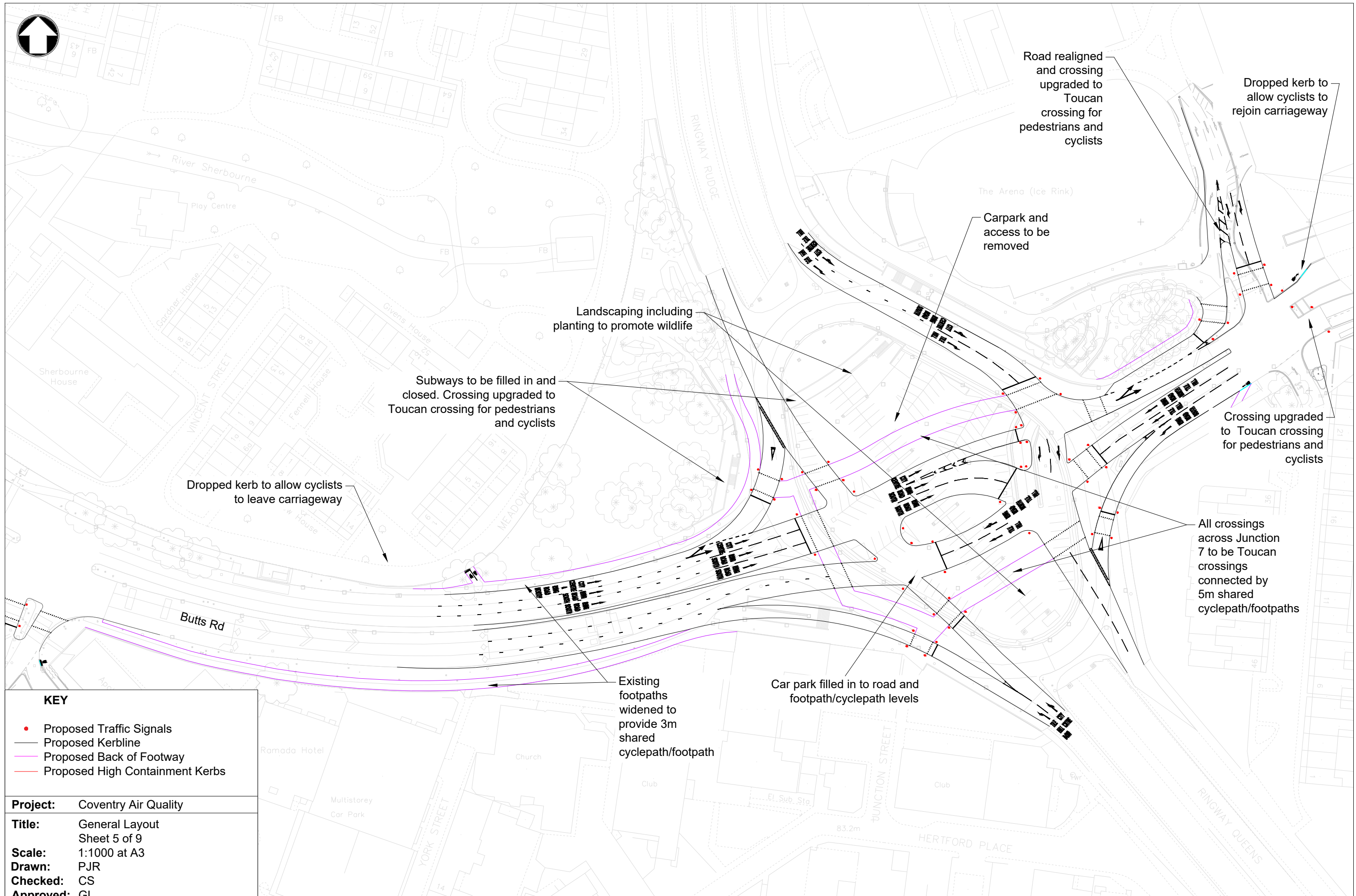

Road realigned and crossing upgraded to Toucan crossing for pedestrians and cyclists

Dropped kerb to allow cyclists to rejoin carriageway

The Arena (Ice Rink)

Carpark and access to be removed

Landscaping including planting to promote wildlife

Subways to be filled in and closed. Crossing upgraded to Toucan crossing for pedestrians and cyclists

Dropped kerb to allow cyclists to leave carriageway

Crossing upgraded to Toucan crossing for pedestrians and cyclists

All crossings across Junction 7 to be Toucan crossings connected by 5m shared cyclepath/footpaths

Existing footpaths widened to provide 3m shared cyclepath/footpath

Car park filled in to road and footpath/cyclepath levels

KEY	
•	Proposed Traffic Signals
—	Proposed Kerblines
—	Proposed Back of Footway
—	Proposed High Containment Kerbs
<b>Project:</b>	Coventry Air Quality
<b>Title:</b>	General Layout Sheet 5 of 9
<b>Scale:</b>	1:1000 at A3
<b>Drawn:</b>	PJR
<b>Checked:</b>	CS
<b>Approved:</b>	GL
<b>Status:</b>	CONSULTATION
<b>Dwg Ref:</b>	101130-MMD-00-XX-DR-C-0036

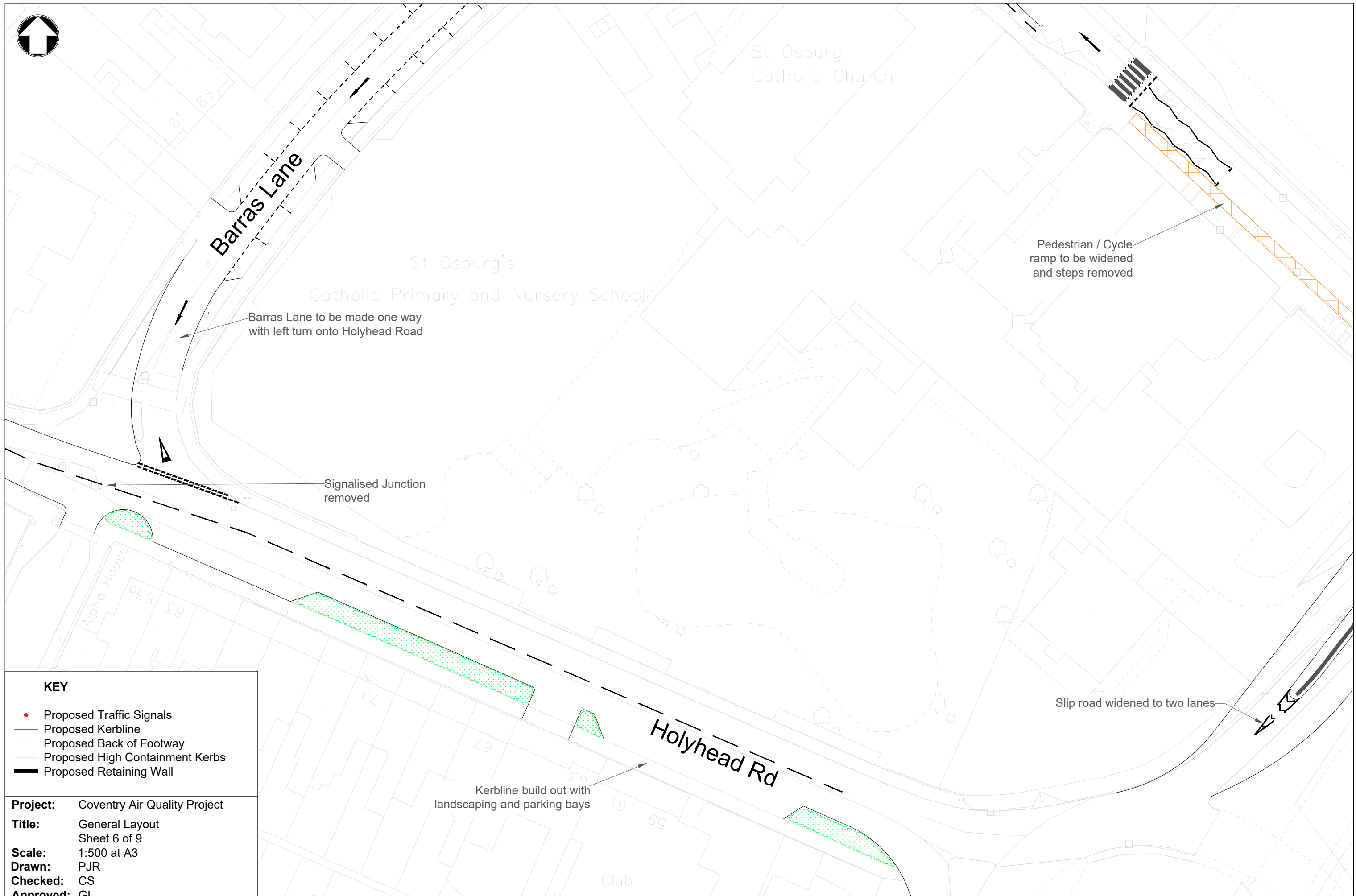

**KEY**

- Proposed Traffic Signals
- Proposed Kerblines
- Proposed Back of Footway
- Proposed High Containment Kerbs
- Proposed Retaining Wall

**Project:** Coventry Air Quality Project

**Title:** General Layout  
Sheet 6 of 9

**Scale:** 1:500 at A3

**Drawn:** PJR

**Checked:** CS

**Approved:** GL

**Status:** CONSULTATION

**Dwg Ref:** 101130-MMD-00-XX-DR-C-0037

Kerblines build out with landscaping and parking bays

Pedestrian / Cycle ramp to be widened and steps removed

Slip road widened to two lanes

Barras Lane to be made one way with left turn onto Holyhead Road

Signalised Junction removed

Alpha House

St Osburg Catholic Church

St Osburg's Catholic Primary and Nursery School

Holyhead Rd

Club





Coundon Cycleway  
Approved Sept 2020

Barras Lane

Upper Hill St

Gospel Hall

St Osburg's  
(Priory)

St Osburg  
Catholic Church

Mast (telecommunication)

Pedestrian crossing

Sandstone wall is retained

Car Park removed  
Parking provided in Barras Lane

Car parking removed & replaced  
by parking in Barras Lane

School pedestrian access

St Osburg's  
Catholic Primary and Nursery School

Pedestrian / Cycle  
ramp to be widened  
and steps removed

Upper Hill Street to  
be left in only from  
Junction 8 slip road

Retaining wall extension

**KEY**

- Proposed Traffic Signals
- Proposed Kerblines
- Proposed Back of Footway
- Proposed High Containment Kerbs
- Proposed Retaining Wall

**Project:** Coventry Air Quality Project

**Title:** General Layout  
Sheet 7 of 9

**Scale:** 1:500 at A3

**Drawn:** PJR

**Checked:** CS

**Approved:** GL

**Status:** CONSULTATION

**Dwg Ref:** 101130-MMD-00-XX-DR-C-0038

Reproduced from the Ordnance Survey base map with permission of the Controller of Her Majesty's Stationary Office, Crown Copyright  
Licence No. 100026294, 2021. Unauthorised reproduction infringes Crown Copyright and may lead to prosecution or Civil Proceedings.

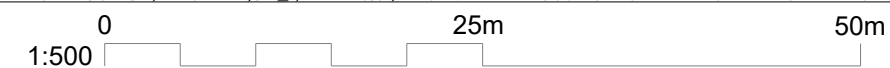

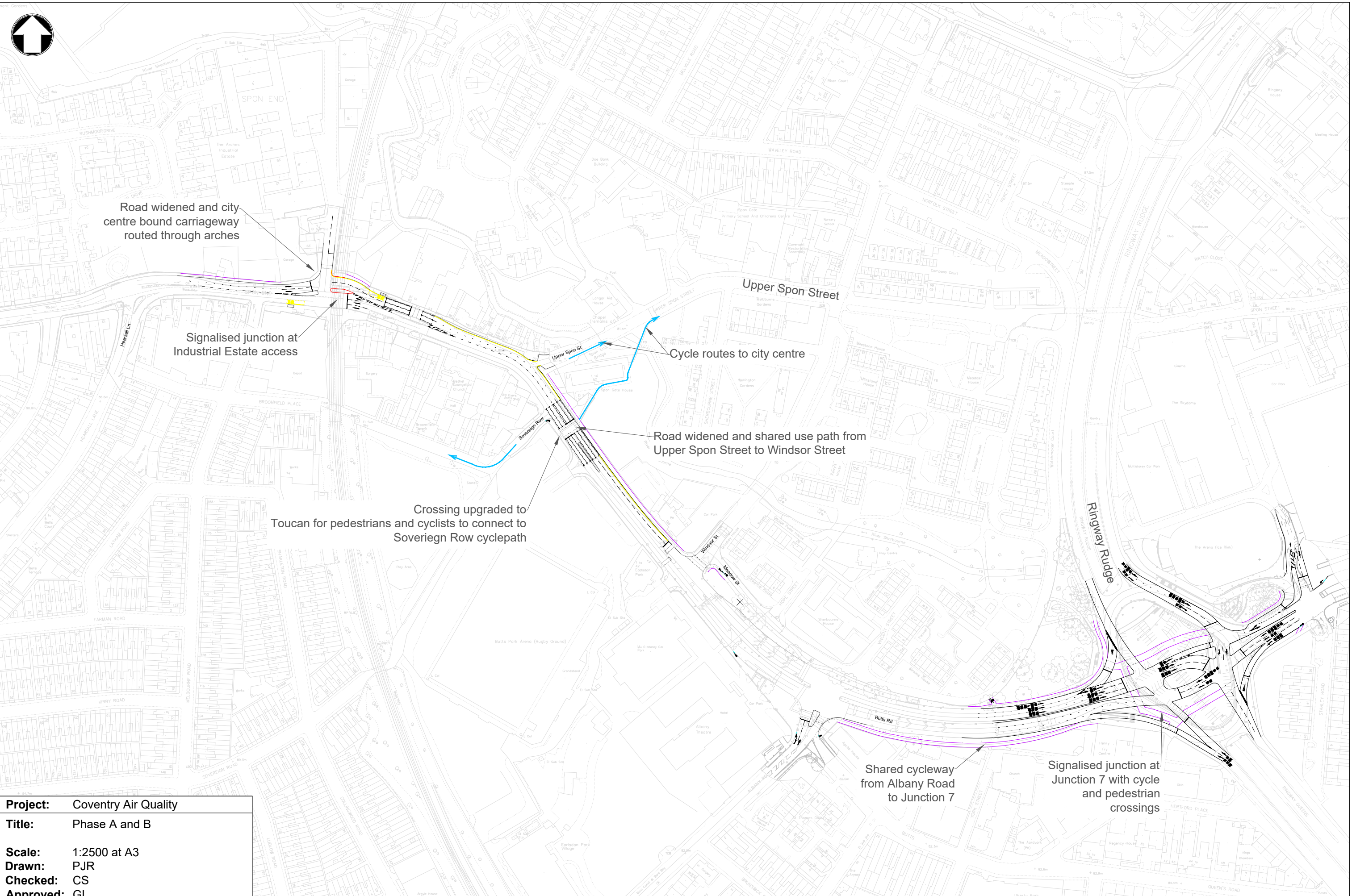

**Project:** Coventry Air Quality  
**Title:** Phase A and B  
**Scale:** 1:2500 at A3  
**Drawn:** PJR  
**Checked:** CS  
**Approved:** GL  
**Status:** CONSULTATION  
**Dwg Ref:** 101130-MMD-00-XX-DR-C-0041

Reproduced from the Ordnance Survey base map with permission of the Controller of Her Majesty's Stationary Office, Crown Copyright  
 Licence No. 100026294, 2021. Unauthorised reproduction infringes Crown Copyright and may lead to prosecution or Civil Proceedings.

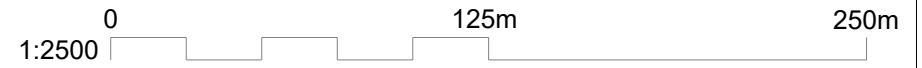



<b>Project:</b>	Coventry Air Quality
<b>Title:</b>	Phase C
<b>Scale:</b>	1:1000 at A3
<b>Drawn:</b>	PJR
<b>Checked:</b>	CS
<b>Approved:</b>	GL
<b>Status:</b>	CONSULTATION
<b>Dwg Ref:</b>	101130-MMD-00-XX-DR-C-0042

Reproduced from the Ordnance Survey base map with permission of the Controller of Her Majesty's Stationary Office, Crown Copyright Licence No. 100026294, 2021. Unauthorised reproduction infringes Crown Copyright and may lead to prosecution or Civil Proceedings.

