

COVENTRY CITY COUNCIL

ENVIRONMENTAL PROTECTION ACT 1990, SECTIONS 8(8), 12

NOTICE OF REVOCATION

91

To: *Midland Lewis Ltd*
Lythalls Lane
Coventry
CV6 6FY

Coventry City Council ("the Council"), in exercise of the powers conferred on it by section 8(8), 12 of the Environmental Protection Act ("the Act"), hereby gives you notice as follows:

1. The authorisation reference 091 is hereby revoked with effect from 7th April 1997.

Signed on behalf of Coventry City Council

.....
City Environment Officer
The officer appointed for that purpose

Date: *17th MARCH 1997*.....

n06031gec

Your reference :
Our reference : **EH/EP/GEC**
Please ask for : **G E Clamp**
Direct Dialling No: **01203 831883**
Date : **12th August 1996**



**Midland Lewis Limited
Units 4 & 5
Binns Close
COVENTRY
CV4 9TB**

**HOUSING AND ENVIRONMENTAL
SERVICES DIRECTORATE**

**Director Howard T. Farrand
Providing Housing, Environmental and
Client Agency Services**

**Michael J. Green
City Environment Officer
Broadgate House
Broadgate
Coventry, CV1 1NH**

Telephone : 01203 83 1832/34
Telecom Gold Mailbox : 76 : END042
Fax : 01203 83 1831

THE ENVIRONMENTAL PROTECTION ACT 1990

**The Environmental Protection (Prescribed Processes and Substances) Regulations
1991, SI 472.**

**The Environmental Protection (Application, Appeals and Registers) Regulations
1991, SI 507.**

**Authorisation No: 091
Application Received: 28th March 1996**

Notice is hereby given that under the Environmental Protection Act 1990 Coventry City Council (hereafter called the Authority) gives authorisation to:

**Midland Lewis Limited
Units 4 & 5
Binns Close
COVENTRY
CV4 9TB**

Register in England No: 3130606

For the manufacture of timber and wood based products as described on Page 2 at:

**Units 4 & 5
Binns Close
COVENTRY
CV4 9TB**

Subject to the conditions specified on the attached pages, Nos 1 to 3, and within the process boundary as indicated on Plan No. 1.

Signed  Dated *9th* day of *August* 199*6*.....
City Environment Officer

CERTIFICATE OF SERVICE BY HAND

I,  being employed
as a *Env. Pollution Officer* in the Housing and
Environmental Services Directorate of
Coventry City Council hereby certify that the
Notice of which this is a true copy was
served/delivered by me to *MIDLAND LEWIS*
of *Units 4-5, Banns Close*, Coventry,
on *12th August* 19 *96*

Signed 

1. DESCRIPTION OF PROCESS

- 1.1 This authorisation is for the manufacture of timber and wood based products, as described under Schedule 1, Section 6.7 of the Environmental Protection (Prescribed Processes and Substances) Regulations 1991, SI472, within the process boundary outlined in red on the attached plan numbered 1 and relates to the process outlined below.
- 1.2 The manufacture of timber and wood based products involving sawing, drilling, moulding, turning, planning and sanding using a variety of individual wood working machines all served by the local electrical ventilation systems for the removal of wood dust and shavings via the bag filter units to one of the two wood dust trailers marked A and E on the attached plan numbered 1.
- 1.3 The priming of products by spray or vacuum application using two Brinks spray booths, the paint shop spray booth, the stair shop spray booth and three vacuum coaters.
- 1.4 Any change to the above process must not take place without the prior consent of this Authority.

2. MONITORING, SAMPLING AND MEASUREMENT OF EMISSIONS

- 2.1 A visual assessment of wood dust emissions from the extraction system shall be carried out, from positions marked X and Y on the attached plan numbered 1, at least once a day whilst the extraction system is in operation.
- 2.2 The results of all monitoring to comply with clause 2.1 above, shall be recorded in a log book which shall include details of date, time, wind strength and direction, weather conditions, the name of the observer and an assessment of the emissions. The log book shall be retained on site for a minimum of two years from the last entry and shall be made available for examination by the Local Authority Inspector on request.
- 2.3 Any adverse results from the monitoring required in clause 2.1 above, shall be investigated immediately to establish the cause and corrective action instigated. Details of such events shall be recorded in the log book.

3. MATERIALS HANDLING

- 3.1 Arisings of wood waste shall be stored in designated containers.
- 3.2 Arisings of wood dust shall be stored in the trailers marked A and E on the attached plan numbered 1.
- 3.3 Arisings of wood dust shall only be transported to the trailers marked A and E on the attached plan numbered 1 via the local extract ventilation system.
- 3.4 The trailers marked A and E on the attached plan numbered 1 shall be fitted with high level side windows to enable a visual assessment to be made to prevent overfilling.

4. GENERAL OPERATIONS

- 4.1 Any mechanical malfunction, spillage or other incident which is likely to give rise to emissions to atmosphere shall be attended to and remedied as soon as possible. Any such incident shall be recorded in the log book described in clause 2.2 above.
- 4.2 All plant and equipment concerned with control of emission to atmosphere shall be maintained in good working order to ensure compliance with the conditions of this Authorisation.
- 4.3 A copy of this Authorisation will be available to all persons having duties or responsibilities which are or maybe affected by this Authorisation.

5. UPGRADING OF THE PROCESS

- 5.1 No later than six months from the date of this Authorisation a programme for upgrading the process will be submitted to this Authority. The upgrading programme shall have regard to the Secretary of States Guidance : The Manufacture of Timber and Wood Based Products PG6/2 (95).

cpa_B_auth/midlewis1

SUPPLEMENTARY NOTES

THESE NOTES ARE NOT PART OF THE AUTHORISATION

1. Your attention is drawn to your obligation under Section 7(2) of the Environmental Protection Act 1990 to ensure that the best available techniques, not entailing excessive cost (BATNEEC) for:
 - A) preventing the release of prescribed substances into the air or where that is not practicable by such means, for reducing the release into the air of such substances to the minimum and for rendering harmless any such substances that are so released
 - and
 - B) for rendering harmless any other substances which might cause harm if released into the air.
2. The authority for contact purposes should be taken to mean the head of the Environmental Protection Section, Tel 831810 during office hours, 832222 outside office hours.

Midland – Lewis Limited

Timber Merchants, Staircase & Joinery Manufacturers

Units 4 & 5, Binns Close, Coventry CV4 9TB.

Telephone: (01203) 464770 & 226571 Fax: (01203) 468347

688886

The company's application for units 2-8 Torrington Avenue and 5-6 Binns Close, which is adjacent to the above premises and interlinked.

- A) Incoming Timber and Sheet Materials (Imports).
- B) Storage of Nominal stores of Timber and Sheet Materials
- C) Handling of Sheet Materials not requiring processing.
- D) Timber requiring resawing and/or machining
- E) The manufacture of staircases
- F) The manufacture of doors and windows
- G) The milling and machining of raw timber
- H) The delivery of timber and manufactured goods

No throughput data is available to quantify total volumes of timber processed per annum due to the recent merger of the two companies. However, for this application, it can be assumed that volumes of raw materials will be approximately 750 m³.

APPENDIX A

The milling in question is the resawing, milling and machining softwood and hardwood timber of both imported and home grown origin. The process also includes the recutting of plywoods, particle boards and Medium Density Fibreboards.

Timber is also stored prior to processing in both open and covered storage areas depending on quality/grade and end usage. Plywoods and sheet materials are stored in covered storage areas. Timber and sheet materials are transported within the process site by mechanical methods ie Sideloaders and counterbalance Lift Trucks.

Timber or plywoods are transferred from storage to mill areas (A & B on Mill Plan) by fork-lift truck for processing.

Machinery used in the operations of resawing, milling and machining sheet material cutting is as shown on the Mill Plan.

After processing, timber that has been resawn is moved to either the timber treatment area for further process or moved directly to a 'Finished Jobs' area prior to loading onto transport for onward to delivery to customers.

Contingency for breakdown is covered in most aspects with our own maintenance team, fully employed by our Company. Any other malfunctions are covered by direct approach to the manufacturers.

APPENDIX "B"

All machinery used in the described processes are connected to one of two new extraction systems, both installed late 1995 by Woodwaste Central and both of which conform to the latest COSHH regulations. A capital list is included and each separate department is clearly marked against the legend as set out below.

Also enclosed is a full site layout and includes detailed machinery location and uses. The extraction points are all clearly denoted and each system marked separately. The extraction system itself is a chain link system, totally encased and with cotton filter bags. The waste is taken through the defuse system and then transferred by fan to filter trailers which are cleared by Arden Wood Shavings who are themselves licensed Waste Disposal Contractors.

Maintenance to all machines and equipment is by our own team of fully qualified engineers and electricians, two in number.

Midland – Lewis Limited

As stated in the introduction to these appendices to this application the company does not expect the operational life of this site to last beyond 1996. Any programme of upgrading to the LEV System will therefore be limited to situations arising from wear and tear which will be dealt with by ongoing general maintenance or as a result of recommendations or requirements made by the local authority inspectorate. Major upgrading work will be undertaken when the company relocates to new premises in the latter part of 1996.

APPENDIX 'C'

Compliance Procedures

To demonstrate compliance with possible authorisation conditions relating to:-

- i. Process Parameters
 - ii. Performance of pollution abatement plant
 - iii. Quality Assurance plans
 - iv. Record Keeping
- the following systems are in place (i), (iii) and (iv)

The effective control of process parameters and record keeping is covered by the companies ongoing objective of the operation and maintenance of Registration and compliance to the requirements of ISO 9002 to which we were accredited in 1994. Continual regular audits are carried out by our own quality auditors and by auditors of our accreditation body TRADA.

(ii) Not applicable - See Appendix 'B'

In-house maintenance team will carry out periodic regular Safety and Environmental Audits of the LEV plant approximately twice a year. Records of these audits will be kept in the form of maintenance records. Training records of all personnel are kept in the company's personnel file held at Binns Close, Coventry.

APPENDIX "E"

Staircase Manufacture.

The Stairshop is under the direct control of Mr Barrie Holland.

Work is passed on to the Shop Floor after confirmation of order.

Material requisites are passed on to the mill whose function for them is to provide detailed profiled timber from raw material stocks. A general stock is held with special requirements requested from the mill on a daily basis.

From receipt of machined and imported goods the stairs are produced to detailed specifications and drawings either provided by the customer or designed in our own offices. Stairs are manufactured to the various degree of assembly to customer requirement. From this stage they are passed to the paint shop for either priming or staining. From finished they are passed to undercover storage ready for distribution.

APPENDIX "D"

The application site at Torrington Avenue and Binns Close, Coventry is under the direct control of Mr Mick Fairbrother, Works Manager, who is responsible to one of the Company's Joint Managing Directors, Mr W H Smith. Each separate department has a section leader, they are monitored on a daily basis by Works Manager. All senior personnel ie. Works Manager, Section Leaders, meet once per week for progress reports etc.

It is the overall responsibility of the joint Managing Directors through their managers etc. to assure compliance with the requirements of the Environmental Protection Act and Health and Safety at Work.

All Senior Staff have been notified that it is their duty to notify the Local Authority of changes in production or working procedures which may affect compliance with the Environmental Act.

APPENDIX "F"

Monitoring, sampling and measurement of air emissions will be carried out twice a year by a qualified consultant and records of these findings will be kept on file.

Midland – Lewis Limited

Timber Merchants, Staircase & Joinery Manufacturers

Units 4 & 5, Binns Close, Coventry CV4 9TB.

Telephone: (01203) 464770 & 226571 Fax: (01203) 468347

ENVIRONMENTAL PROTECTION ACT

APPLICATION FOR AUTHORISATION OF AN EXISTING PART B PROCESS

Introduction

Midland-Lewis Limited is a privately owned timber Importer and Joinery Manufacturer operating currently from the sites in Coventry, Foleshill, Parkstone Road and the site to which this application refers, units 4 & 5, Binns close, Coventry.

It should be noted that by the end of 1996 the company plans to relocate to larger premises in Coventry for which contracts have been exchanged, thus closing down its three existing sites and accommodating its entire operation on one major site. This application is therefore of a temporary status and will, by the end of 1996, be subject to substantial change.

The company's operation at this application site situated at units 4 & 5, Binns close, Coventry consists of six components:-

- a) Incoming timber and sheet materials (imports).
- b) Storage of timber and sheet materials
- c) Handling of timber and sheet materials not requiring further processing.
- d) Timber requiring resawing and/or milling.
- e) Timber requiring pre-treatment with preservative.
- f) Delivery of timber and sheet materials to customers.

The elements for which Part B Authorisation is required, d) and e), are further described on the data packages and plans accompanying this application.

No actual throughput data is available to quantify total volumes of timber processed per annum, however, for the purpose of this application, it can be assumed that volumes in excess of 1000 m³ will be processed.

S. & D. EXTRACTION CO. LTD.

SHAVINGS AND DUST EXTRACTION

Unit 7/8 Woodlands Farm, Spring Lane, Cookham Dean, Berk's. SL6 9PL
Tel.: 01628 486111. Fax: 01628 486220

MIDLAND LEWIS LTD
BINNS CLOSE
COVENTRY
CV4 9TB

Date 17 Jan 1996

For the attention of Mr W. Smith.

Dear Bill

Please find enclosed results of L.E.V. test carried out at your premises on 16 Jan 1996, as you can see the extraction rate is slightly down in the window shop, I am currently looking into the possibility of increasing the speed of the main fan by altering the pulley dimensions, I will of course keep you informed of any changes that will need to be implemented to increase velocity.

I hope you understand the enclosed, if you need any further information please do not hesitate to contact me.

Kind regards

Steve



S. & D. EXTRACTION CO. LTD.

SHAVINGS AND DUST EXTRACTION

Unit 7/8 Woodlands Farm, Spring Lane, Cookham Dean, Berk's. SL6 9PL
Tel.: 01628 486111. Fax: 01628 486220

Page two of five

JOINERY SHOP

<u>MACHINE & NUMBER</u>	<u>DUCT SIZE</u>	<u>VELOCITY</u>	<u>CFM</u>
Slot tennon	125mm	2539	360
Wadkin moulder J02	400mm	2800	4000
Cross cut saw J11	125mm	2800	390
CNC DET J09 <i>As above</i>	300mm	3942	3200
	300mm	3900	3200
Spindle J16	150mm	3556	700
Spindle J17	150mm	2868	580

S. & D. EXTRACTION CO. LTD.

SHAVINGS AND DUST EXTRACTION

Unit 7/8 Woodlands Farm, Spring Lane, Cookham Dean, Berk's. SL6 9PL
Tel.: 01628 486111. Fax: 01628 486220

MIDLAND LEWES LTD

L.E.V. TEST RESULTS.
DOOR SHOP

Date 16 Jan1996

Page one of five.

<u>MACHINE & NUMBER</u>	<u>DUCT SIZE</u>	<u>VELOCITY</u>	<u>CFM</u>
Single end tennon DS04	150mm	4300	850
	150mm	3812	760
Single end tennon DS05	150mm	4552	860
	150mm	3995	780
Spindle DS06	125mm	4539	620
Spindle DS07	125mm	4531	620
Drum sander DS03	180mm	4223	1100
	180mm	5224	1350
Dimension saw DS12	125mm	4752	650
Wadkin moulder	300mm	4951	3900
Cross cut saw DS09	125mm	4570	620
De-nibber J18	125mm	4643	630
	125mm	4020	560
	180mm	4946	1350

S. & D. EXTRACTION CO. LTD.

SHAVINGS AND DUST EXTRACTION

Unit 7/8 Woodlands Farm, Spring Lane, Cookham Dean, Berk's. SL6 9PL
Tel.: 01628 486111. Fax: 01628 486220

Page three of five.

MAIN MILL

MACHINE & NUMBER	DUCT SIZE	VELOCITY	CFM
Wienig moulder M16	400mm	3058	4400
Re-saw M01	150mm	1408	280
Wadkin 6 head M14	450mm	3296	5600
Wadkin 5 head M17	400mm	4306	5800
Profimat	250mm	2565	1400
Multi-rip saw M13	180mm	4717	1400
MPS cross cut M05	150mm	3868	750
	150mm	2400	480

S. & D. EXTRACTION CO. LTD.

SHAVINGS AND DUST EXTRACTION

Unit 7/8 Woodlands Farm, Spring Lane, Cookham Dean, Berk's. SL6 9PL
Tel.: 01628 486111. Fax: 01628 486220

Page five of five

STAIR SHOP

<u>MACHINE & NUMBER</u>	<u>DUCT SIZE</u>	<u>VELOCITY</u>	<u>CFM</u>
Cross cut saw S12	125mm	3700	520
Panel saw	150mm	3591	710
Rip-saw S05	125mm	4220	580
Spindle S03	125mm	3800	540
O/U S16	150mm	3000	600
Router S10	125mm	3734	520
5 Head tennon S11	150mm	3617	720
	150mm	4305	850
Sander S07	250mm	4778	2620
Zuckerman S13	250mm	3028	1700
Albus lathe S17	100mm	3700	340
	150mm	4765	920

S. & D. EXTRACTION CO. LTD.

SHAVINGS AND DUST EXTRACTION

Unit 7/8 Woodlands Farm, Spring Lane, Cookham Dean, Berk's. SL6 9PL
Tel.: 01628 486111. Fax: 01628 486220

Page four of five

UNIT 8

<u>MACHINE & NUMBER</u>	<u>DUCT SIZE</u>	<u>VELOCITY</u>	<u>CFM</u>
CNC router U803	200mm	4500	1600
Re-saw U824	150mm	4995	980
Moulder U802	450mm	4176	7400
MPS cross cut U805	150mm	4400	850
Rip saw U812	150mm	4747	920
Panel saw U813	150mm	3760	750
Surface planer U822	150mm	3963	780
Cross cut saw U826	125mm	4033	820
Cross cut saw	125mm	800	120 blocked
Spindle U814	125mm	800	120 blocked
Spindle U816	180mm	4606	1200
Spindle U815	180mm	4119	1100
Sagar tennon U818	200mm	blocked	
Cross cut saw U819	125mm	3397	460

Unit 8

Midland - Lewis Limited

Dept: Unit 8

Machine List:-

Number	Description	M/C Serial No:	M/C Test No:
U801	Interwood Double End Tenoner		
U802	Wadkin Gem Moulder		
U803	Wadkin CNC Router	UX 3 FC 03	92599
U804	Timber Techniques R F Press	Type 20 88P204	
U805	Wadkin MPS Cross Cut Saw		
U806	Infeed Rollers (X-Cut)		
U807	Outfeed Rollers (X-Cut)		
U808	Cross Transfer Unit (X-Cut)		
U809	Infeed Scissor Lift (X-Cut)		
U810	Outfeed Scissor Lift (GEM)		
U811	Waste Conveyor System (X-Cut)		
U812	Rip Saw Bench	20 BSW 65906	
U813	Panel Saw	12 BGP 681226	
U814	Wilson Spindle Moulder Power Feed		
U815	Spindle Moulder Power Feed	BER2 81936	
U816	Wadkin Spindle Moulder Power Feed	EQ 2306	96177
U817	Wadkin Morticer	MA415	15580
U818	Sagar Tenoner	9237NN BT 9174	
U819	Robinson Cross Cut	X/E 389 71/10	
U820	Hydraulic Cramp		
U821	Air Dryer		
U822	Surface Planer	8400 83834	
U823	Wadkin Super Saw	Super 7221	
U824	Stenner Resaw	VH/M36 Q3832	
U825	Heater		
U826	Cross Cut		
U827	Wadkin CNC Double End Tennonner	DA64/c 84150	84150
U828	Binnks Spray Booth		
U829	Twin Blade Mitre Guillotine		

Paint Shop

Midland - Lewis Limited

Dept: Paint Shop

Machine List:-

Number	Description	M/C Serial No:	M/C Test No:
PS01	Vacuum Coater		
PS02	Vacuum Coater		
PS03	Vacuum Coater		
PS04	Compressor	205041	
PS05	Glass Washer		
PS06	Spray Booth		
PS07	Air Drier Unit		
PS08	Heater		
PS09	Heater		

Tool Room

Midland - Lewis Limited

Dept: Tool Room

Machine List:-

Number	Description	M/C Serial No:	M/C Test No:
TR01	Wadkin NV230 Profile Grinder	NV 119	89119
TR02	Wadkin Universal Grinding Machin	NH 266	49418
TR03	Wadkin Ultrasonic Cleaning Tank		
TR04	Weineg Setting Stand		
TR05	Weineg Optical Setting Stand		
TR06	Wadkin Setting Stand		
TR07	Bench Grinder		

Stairs

Midland - Lewis Limited

Dept: Stairs

Machine List:-

Number	Description	M/C Serial No:	M/C Test No:
S01	Ereadi Galloi Mario Linsher (U8)	IVG 120 9/1976	
S02	Wadkin Chain And Chisel	MP14159	
S03	Wadkin Spindle EP	EPA4675	
S04	Sager Band Saw	MS020	
S05	Wadkin Rip Saw		
S06	Stair Cramp		
S07	Twin Sander And Extractor	0D60	
S08	Colchester Student Lathe		
S09	Air Compressor	1673901	
S10	SCM Router		
S11	5 Head Tenoner	BW 35600	
S12	Cross Cut Saw (De Walt)	14205	
S13	Zukerman Copy Lathe (U8)	3220	
S14	3.3m Spray Booth		
S15	Picle's Stair Trencher	4826/2	
S16	Wadkin Planer / Thicknesser	180795	
S17	Albus Hapfo Centre Lathe (U8)	AP/5000 6736	
S18	3 Bag Extraction Unit (U8)		
S19	Dimension Saw		
S20	Pillar Drill		
S21	Air Drier Unit		
S22	Air Tank		

Joinery

Midland - Lewis Limited

Dept: Joinery

Machine List:-

Number	Description	M/C Serial No:	M/C Test No:
J01	Hydraulic Cramp	153	
J02	Wadkin Moulder	GEM 205/159	86044
J03	Weing Profile Grinder		
J04	Binks Spray Booth	Cannot Find No.	
J05	R+S Morticer & Tenoner	589112	
J06	Robinson Tenoner	494 SCE	59/307
J07	Morticer	615	
J08	Band Saw	159 SL/E	
J09	CNC Double Ended Tenoner	DP 1153	94183/4
J10	Wadkin Router		
J11	Cross Cut		
J12	Surface Planer	Plate Missing	
J13	Heater		
J14	Airless Spray Pump		
J15	Double Ended Nibbler	1223691	
J16	Spindle Moulder	EQ 4185	88217
J17	Spindle Moulder	DECOMMISSIONED	
J18	Denibber (CB)	1475	VERA 1300
J19	SCM Spindle Moulder T130H	AB6504	090116

Mill

Midland - Lewis Limited

Dept: Mill

Machine List:-

Number	Description	M/C Serial No:	M/C Test No:
M01	Stenner Eagle Bandsaw 36"		
M02	Aircom Air Compressor (Hydrovane)	140 Air Centre	
M03	Chains Cable & Scissor Lift		
M04	Samco Feed Unit (Multi Rip)		
M05	Wadkin MPS Cross Cut Saw	MPS14137	
M06	Chain Driven Conveyor (Out feed M/rip)		
M07	Pneumatic Tilt Table (Cross Cut)		
M08	Pneumatic Tilt Table (Multi Rip)		
M09	Chain Driven Cross Transfer (Cross cut)		
M10	Chain Driven Cross Transfer (M/Rip)		
M11	Roller Track System (Cross Cut-M/Rip)		
M12	Pneumatic Rake System (Cross Cut)		
M13	SCM Multi Rip Saw	M2 AB 527	Ref. 020115
M14	XE220 6 Head Planer Moulder	XE 445	94275
M15	Wadkin Throughfeed Pre-straightener	GA5202	90813
M16	Weinig Moulder	P22N 226-3438	
M17	5 Head Moulder (Calder Wilk)	FBP 9021	89274
M18	Oil Fired Heater		
M19	Trepel 6 Ton Scissor lift (P/E)		

Door Shop

Midland - Lewis Limited

Dept: Door Shop

Machine List:-

Number	Description	M/C Serial No:	M/C Test No:
DS01	Morticer	MFT 175	4693
DS02	Hydraulic Cramp	SP 84 09 013	
DS03	Wide Belt Sander	371093283	
DS04	Single Ended Tenoner		
DS05	Single Ended Tenoner	EKA 1062	48984
DS06	Spindle Moulder	BR56582	
DS07	Spindle Moulder	EQ1123	57546
DS08	Gang Morticer	1673	
DS09	Cross cut		
DS10	Heater		
DS11	Profile Router		
DS12	Dimension Saw	BGP	
M15	Wadkin Moulder (GA)	GA5202	908.13

Extraction

Midland - Lewis Limited

Dept: Extraction

Machine List:-

Number	Description	M/C Serial No:	M/C Test No:
EX01	Mill Extraction		
EX02	Unit 8 Extraction		
EX03	Door Shop Extraction	1400 DB	
EX04	Joinery Extraction		
EX05	Stairs Extraction		

Midland - Lewis Limited

MAINTENANCE JOB CARD

Date

Department

Plant Number

Machine Number

Work Details

Midland - Lewis Limited

MAINTENANCE JOB CARD

Date

Department

Plant Number

Machine Number

Work Details

Midland - Lewis Limited

MAINTENANCE JOB CARD

Date

Department

Plant Number

Machine Number

Work Details

Midland - Lewis Limited

MAINTENANCE JOB CARD

Date

Department

Plant Number

Machine Number

Work Details

Planchest

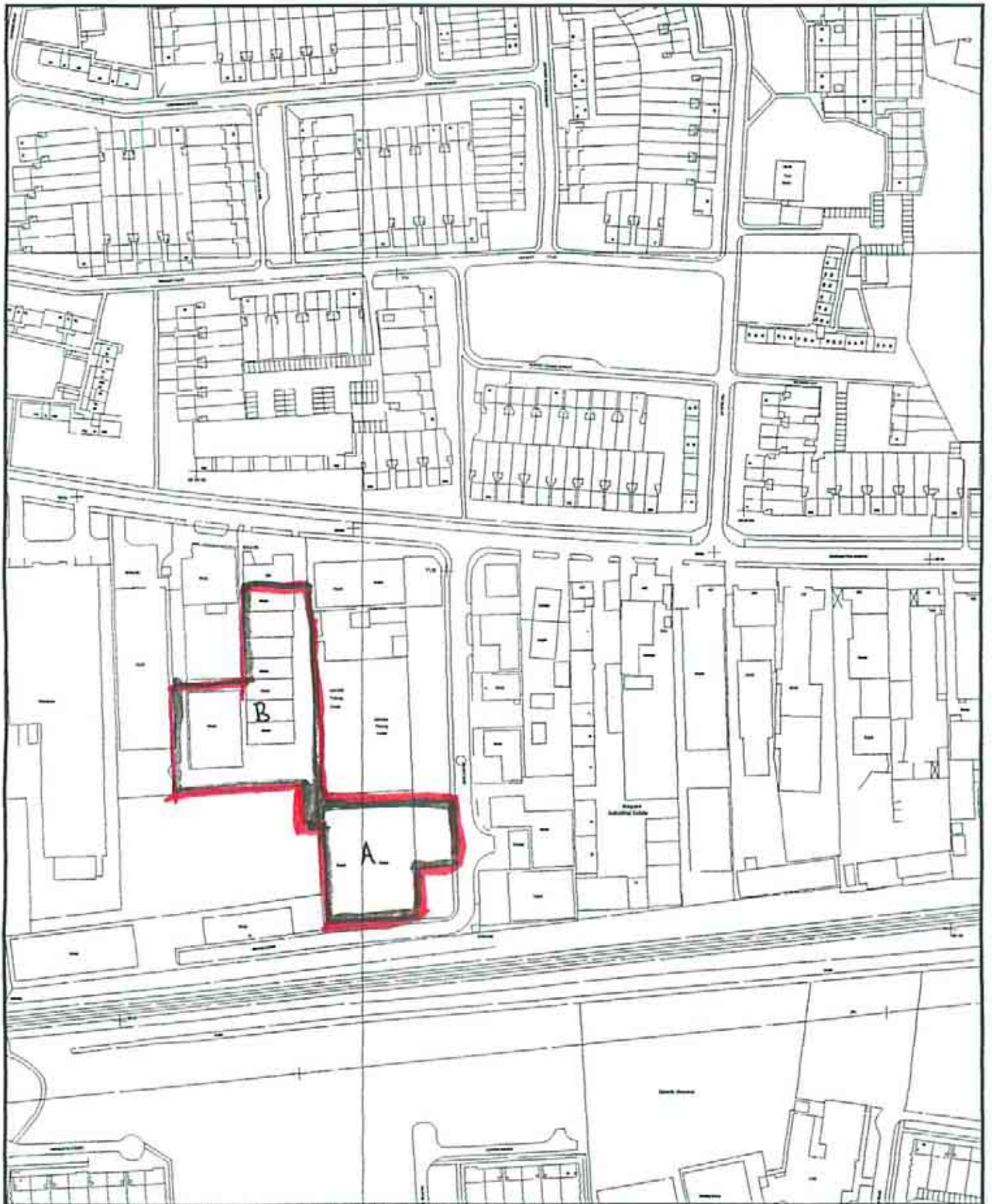

Materials Contained in this map are reproduced from OS Survey Maps
with the permission of the Controller of Her Majesty's Stationary Office.
Crown Copyright. Licence No:076155(LA) .COVENTRY CITY COUNCIL
Output On Plan Chest

Scale:1:2500
Plot Date:15/2/1996
By:HAZEL EVANS
Dept:CITY DEVELOPMENT