

**Part B Variation Form**  
**Application for a Variation of Permit Conditions**

**Pollution Prevention and Control Act, 1999**

**Pollution Prevention and Control (England and Wales) Regulations 2000 (as amended)**

**Local Authority Pollution Prevention and Control**

**INTRODUCTION**

**When to use this form**

This regime is known as Local Authority Integrated Pollution Prevention and Control, LAPPC. Installations permitted under this regime are known as **Part B** installations. Use this form if you already have a permit and wish to vary the permit conditions or wish to make a change to your installation.

**Before you start to fill in this form**

Please read the DEFRA general guidance manual issued for LA-IPPC and LAPPC. This contains a list of other documents you may need to refer to when you are preparing your variation application and explains some of the technical terms used. You will also need to read the relevant sector guidance note, BREF note or process guidance note as relevant. The Pollution Prevention and Control (England and Wales) Regulations 2000 can be obtained from The Stationary Office, or viewed on their website at: [www.legislation.hmso.gov.uk/si/si2000/20001973.htm](http://www.legislation.hmso.gov.uk/si/si2000/20001973.htm).

**Which parts of the form to fill in**

You should fill in as much of this form as possible. The appropriate fee must be enclosed with the variation application to enable it to be processed further. When completed return to:

**Public Protection**  
**Coventry City Council**  
**Broadgate House**  
**Broadgate**  
**Coventry**  
**CV1 1NH**

**Other documents you may need to submit**

There are a number of other documents you may need to send us with your variation application. Each time a request for a document is made in the form you will need to record a document reference number for the document or documents that you are submitting in the space provided on the form for this purpose. Please also mark the document(s) clearly with your permit reference number and the name of the installation.

**Using continuation sheets**

In the case of the questions on the form itself, please use a continuation sheet if you need extra space; but please indicate clearly on the form that you have done so by stating a document reference number for that continuation sheet. Please also mark the continuation sheet itself clearly with the information referred to above.

**Copies**

Please send the original and three copies of the form and all other supporting material, to assist consultation.

**If you need help and advice**

We have made the form as straightforward as possible, but please get in touch with us at the Local Authority address given above if you need any advice on how to set out the information we need.

# LAPPC Variation Application Form

## to be Completed by the Operator

For Local Authority use		
Installation Reference:	Officer Reference:	Date Received:

### A 1.1 Name of the Installation

MIDLAND STEEL STRUCTURES LTD

### A 1.2 Please Give the Address of the Site of the Installation

PLOT V GOLDEN ACRES LANE, BINLET, COVENTRY

Postcode: CV3 2RT

Telephone Number: 02476 445584

### A 1.3 Permit Reference Number

AUTHORISATION N° 63

### A 2.1 The Operator - please Provide the Full Name of Company or Corporate Body

Trading / Business Name: (if different)

AS REGISTERED OFFICE ADDRESS

Registered Office Address:

MIDLAND STEEL STRUCTURES LTD, GOLDEN ACRES LANE,  
BINLET, COVENTRY

Postcode: CV3: 2RT

Principal Office Address: (if different)

MIDLAND STEEL STRUCTURES LTD., GOLDEN ACRES LANE,  
BINLET, COVENTRY

Postcode: CV3. 2RT.

Company Registration Number:

2035144

### A 3.1 Who can we Contact about your Application for a Variation?

*It will help us to have someone who we can contact directly with any questions about your application. The person you name should have the authority to act on behalf of the operator. This could be an agent or consultant rather than the operator.*

Name: A.W.T. ATKINS

Position: WORKS MANAGER

Address: MIDLAND STEEL STRUCTURES LTD, GOLDEN ACRES LANE,  
BINLET, COVENTRY

Postcode: CV3: 2RT.

Telephone Number: 02476 445584.

Fax Number: 02476 459995

E-mail Address:

## B 1 ABOUT THE INSTALLATION

Please fill in the table below with details of all the current activities and proposed activities at the whole installation.

### In Column 1a      **Activities in the Stationary Technical Unit**

Please identify all activities listed in Schedule 1 of the PPC Regulations that are carried out in the stationary technical unit of the installation.

### In Column 1a(i)      **Proposed New Activities in the Stationary Technical Unit**

Please identify all activities listed in Schedule 1 of the PPC Regulations that are proposed to be carried out in the stationary technical unit of the installation.

### In Column 1b      **Directly Associated Activities**

Please identify any directly associated activities that are carried out on the same site which:

- have a technical connection with the activities in the stationary technical unit,
- could have an effect on pollution.

### In Column 1b(i)      **Directly Associated Activities**

Please identify any directly associated activities that are proposed to be carried out on the same site which:

- have a technical connection with the activities in the stationary technical unit,
- could have an effect on pollution.

### In Column 2      **Schedule 1 References**

Please quote the Chapter number, Section number, then Paragraph and Sub-paragraph number as shown in Part 1 of Schedule 1 of the PPC Regulations. For example, *Manufacturing glass where the use of lead or any lead compound is involved*, would be listed as Chapter 3, Section 3.3, Part B(b).

---



## B 1.2 Why is the Variation Application Being Made?



Specific permit conditions will require amending [Regulation 17(2)].



We are unsure whether the proposed changes will require a variation and wish the Local Authority to determine this (Regulation 16).

## B 1.3 Site Maps

Please provide:

- A suitable map showing the location of the installation clearly defining extent of the installations in red and indicating the extent of the installation affected by the proposed change.

Document Reference: H1302 - ONE REV 'F'

- A suitable plan showing the layout of activities on the site, including bulk storage of materials, waste storage areas and any external emission points to atmosphere, indicating which activities will be affected by the proposed change.

Document Reference: H1302 - ONE REV 'F' NOTE NO PAINT STORES AT PLOT 'V'  
& D05 2843/19.

- A suitable plan showing the site drainage system and all discharge points to drainage or water courses, indicating which will be affected by the proposed change.

Document Reference: N/A

## B 2 THE INSTALLATION

Please provide written information about the aspects of your installation listed below. We need this information to determine whether you will operate the installation in a way in which all the environmental requirements of the PPC Regulations are met.

### B 2.1

Describe the proposed change to the installation and activities and identify the foreseeable emissions to air from effecting this change (this will include any foreseeable emissions during start up, shut down and any breakdown/abnormal operation).

The use of process flow diagrams may aid to simplify the operations.

Document Reference: THE VOLUME OF STRUCTURAL STEELWORK TO BE COATED AT PLOT 'V' WAS ORIGINALLY PRODUCED AT PLOT Y2 AT CLAY BROOKS COURT IND EST BINLEY COVENTRY AND TRANSFERRED TO OUR MAIN WORKS AT GOLDEN ACRES LAVE FOR COATING THEREFORE NO SIGNIFICANT CHANGE IN EMISSIONS IS ENVISAGED. <sup>6</sup>

## B 2.2

Once all foreseeable changes in emissions as a result of the proposed change have been identified, each emission should be characterised (including odour) and quantified.

**Atmospheric emissions** should be categorised under the following:

- i. Point source (e.g. chimney/vent, identified by a number and detailed on a plan).
- ii. Fugitive source (e.g. from stockpiles / storage areas).

Document Reference: DRAWING H1302-01E-REV 'F' (NO CHANGE IN STORAGE AREAS)

## B 2.3

For each emission which will be affected by the proposed change, describe the current and proposed technology and other techniques for preventing or, where that is not practicable, reducing the emissions.

Document Reference: FILTERS FITTED TO THE VENT SYSTEM & SOLVENT REDUCTION  
ROUTE MANAGEMENT SYSTEM

## B 2.4

Describe the proposed measures for additional monitoring of all identified emissions as a result of the proposed change.

Document Reference: BS:150 9096 (2003)

## B 2.5

Describe the effect the proposed change will have on your environmental management techniques in relation to the installation activities described.

Document Reference: N/A

**B 2.6**

Detail in the table provided below, or on an additional sheet if preferred, the exact conditions you wish to change in your current permit.

Permit Condition Reference	Proposed New Wording of Condition
AUTHORISATION N°63	To INCLUDE PLOT 'V' GOLDEN ACRES LANE, BINLEY, COVENTRY

**B 2.7 Additional Information**

Please supply any additional information which you would like us to take account of in considering this variation application.

Document Reference:           N/A



## C 1 FEES AND CHARGES

The enclosed charging scheme leaflet gives details of how to calculate the variation application fee. Your application cannot be processed unless the correct fee is enclosed.

### C 1.1 Please State the Amount Enclosed as a Fee for this Variation Application

£ N/A.

Cheques should be payable to:

We will confirm receipt of this fee when we write to you acknowledging your variation application.

### C 1.2

Please give any company purchase order number or other reference you wish to be used in relation to this fee.

N/A.

---

## C 2 ANNUAL CHARGES

The application or granting of a permit variation will not affect the level of your annual subsistence charge, nor the requirement to pay it.

## C 3 COMMERCIAL CONFIDENTIALITY

### C 3.1

Is there any information in the application for a variation that you wish to justify being kept from the public register on the grounds of commercial confidentiality?

No

Yes

Please provide full justification, considering the definition of commercial confidentiality within the PPC Regulations.

Document Reference: \_\_\_\_\_

### C 3.2

Is there any information in the application for a variation that you believe should be kept from the public register on the grounds of national security?

No

Yes

Do not write anything about this information on this form. Please provide full details on separate sheets, plus provide a copy of the variation application form to the Secretary of State for a Direction on the issue of National Security.

### C 4 DATA PROTECTION

The information you give will be used by the Local Authority to determine your application for a variation. It will be placed on the relevant public register and used to monitor compliance with the permit conditions. We may also use and/or disclose any of the information you give us in order to:

- Consult with the public, public bodies and other organisations.
- Carry out statistical analysis, research and development on environmental issues.
- Provide public register information to enquirers.
- Investigate possible breaches of environmental law and take any resulting action.
- Prevent breaches of environmental law.
- Assess customer service satisfaction and improve our service.

We may pass on the information to agents/representatives who we ask to do any of these things on our behalf.

It is an offence under Regulation 32 of the PPC Regulations, for the purpose of obtaining a variation to a permit (for yourself or anyone else) to:

- Make a false statement which you know to be false or misleading in a material particular.
- Recklessly make a statement which is false or misleading in a material particular.

If you make a false statement:

- We may prosecute you, and
- If you are convicted, you are liable to a fine or imprisonment (or both).

## C 5 DECLARATION

### C 5.1 Signature of Current Operator(s)\*

I / We certify that the information in this variation application is correct. I / We apply for a permit in respect of the particulars described in this variation application (including supporting documentation) I / we have supplied.

Please note that each individual operator must sign the declaration themselves, even if an agent is acting on their behalf.

For the Variation Application from: MIDLAND STEEL STRUCTURES

Installation Name: PLOT 'V', GOLDEN ACRES LANE, BINLEY, COVENTRY

Signature: 

Name: A. G. HERNON

Position: MANAGING DIRECTOR

Date: 21-2-06

Signature: 

Name: L. J. HERNON

Position: DIRECTOR

Date: 21/2/06

\* Where more than one person is defined as the operator, all should sign. Where a company or other body corporate - an authorised person should sign and provide evidence of authority from the board of the company or body corporate.

Scale 1/1250

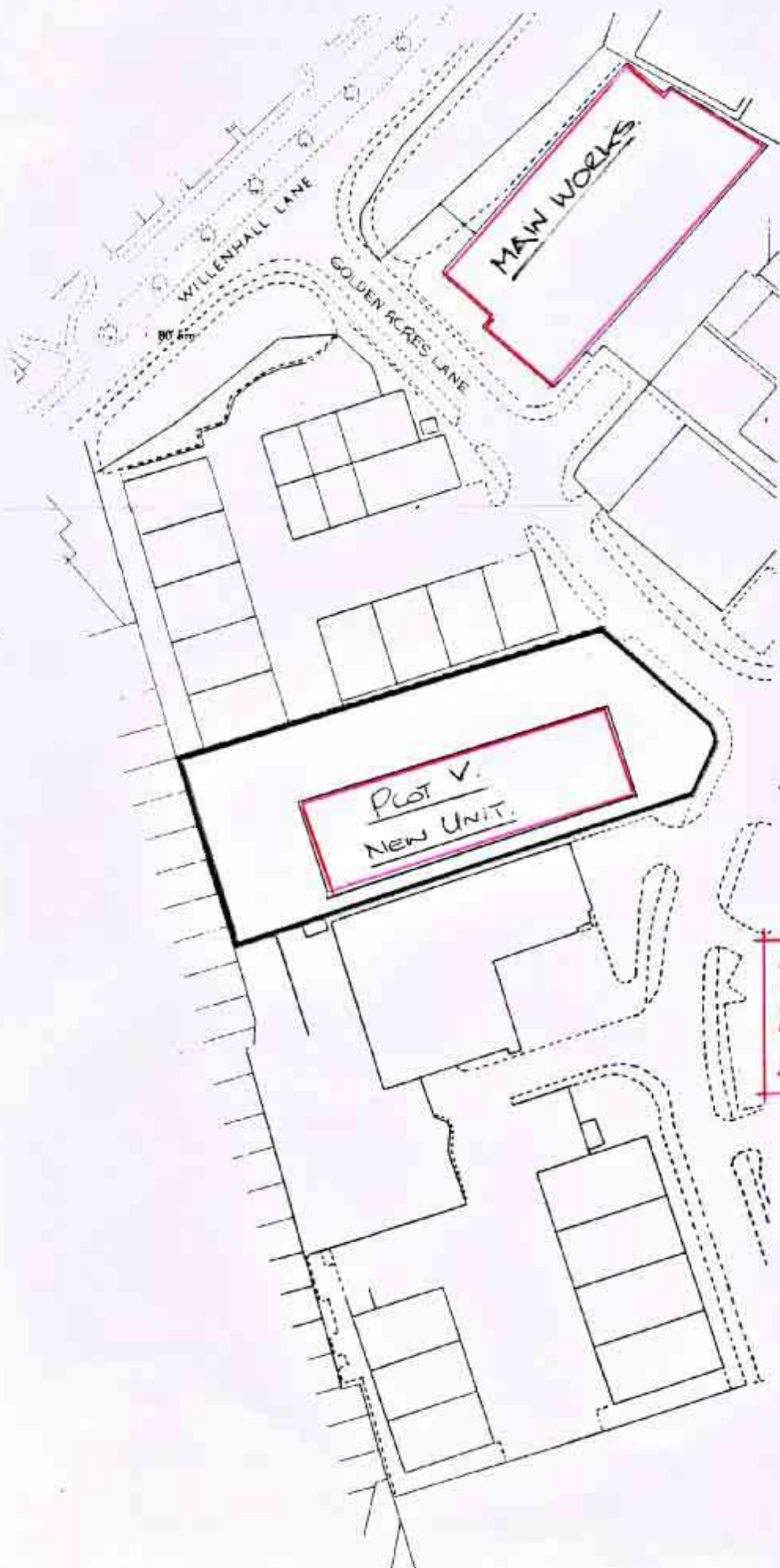

Block Plan Showing  
Location of New Unit  
& Main Works