



Coventry City Council

**Part B Application Form
Application for a Permit
Pollution Prevention and Control Act, 1999
Environmental Permitting (England and Wales) Regulations 2010**

INTRODUCTION

1. When to use this form

This regime is known as Local Authority Pollution Prevention and Control, LAPPC. Installations permitted under this regime are known as **Part B** installations. Use this form if you are sending an application for a 'Part B' permit to Coventry City Council under the Environmental Permitting Regulations 2010 ("the EP Regulations").

2. Before you start to fill in this form

You are strongly advised to read relevant parts of the Defra general guidance manual issued for LAPPC, republished in 2008 and available at:

<http://www.defra.gov.uk/environment/quality/pollution/ppc/localauth/pubs/guidance/manuals.htm>. This contains a list of other documents you may need to refer to when you are preparing your application, and explains some of the technical terms used. You will also need to read the relevant Process Guidance ("PG") Note for your process:

<http://www.defra.gov.uk/environment/quality/pollution/ppc/localauth/pubs/guidance/notes/index.htm>. The EP Regulations can be obtained from The Office of Public Sector Information or viewed on their website at:

http://www.opsi.gov.uk/si/si2007/uksi_20073538_en_1

3. Which parts of the form to fill in

You should fill in as much of this form as possible. The appropriate fee must be enclosed with the application to enable it to be processed further. When completed return to:

**Environmental Protection, Coventry City Council
Room 314 Broadgate House, Broadgate
Coventry CV1 1NH**

4. Other documents you may need to submit

There are a number of other documents you may need to send us with your application. Each time a request for a document is made in the application form you will need to record a document reference number for the document or documents that you are submitting in the space provided on the form for this purpose. Please also mark the document(s) clearly with this reference number and the application reference number (if you have been given one, it will be at the top of the form overleaf). If you do not have either of these, please use the name of the installation.

5. Using continuation sheets

In the case of the questions on the application form itself, please use a continuation sheet if you need extra space; but please indicate clearly on the form that you have done so by stating a document reference number for that continuation sheet. Please also mark the continuation sheet itself clearly with the information referred to above.

6. Copies

Please send the original and **three** copies of the form and all other supporting material, to assist consultation.

7. If you need help and advice

We have made the application form as straightforward as possible, but please get in touch with Environmental Protection on 0500 834333 or email env.protection@coventry.gov.uk if you need any advice on how to set out the information we need.

LAPPC Application Form : to be Completed by the Operator

For Local Authority use		
Application Reference:	Officer Reference:	Date Received:

A 1.1 Name of the Installation

~~OXYGEN POWDER COATING PAINT PLANT~~ (COUPRESS)

A 1.2 Please Give the Address of the Site of the Installation

COUPRESS.

BURNSALL ROAD, CANLEY

COVENTRY Postcode: CVS 6RT

Telephone Number: 02476 691000

Ordnance Survey National Grid Reference: 8 characters

For example SJ 123 456

S P 3 0 5 7 7 8

A 1.3 Existing Permit

Please give details of any existing LAPPC or LA-IPPC permit for the installation, including reference number(s):

NONE

Please provide the information requested below about the "Operator", which means the person who it is proposed will have control over the installation in accordance with the permit (if granted).

A 2.1 The Operator - please Provide the Full Name of Company or Corporate Body

COUPRESS HOLDING LTD

Trading / Business Name: (if different)

Registered Office Address:

BURNSALL ROAD

CANLEY

COVENTRY

Postcode: CVS 6RT

Principal Office Address: (if different)

Postcode: _____

Company Registration Number:

2575621

A 2.2 Holding Companies

Is the operator a subsidiary of a holding company within the meaning of Section 736 of the Companies Act 1985?

No

Yes

Name of Ultimate Holding Company:

COUPRESS INTERNATIONAL HOLDINGS LTD

Registered Office Address:

BURNSALL ROAD

CANLEY

COVENTRY

Postcode: CVS 6RT

Principal Office address: (if different)

Postcode: _____

Company Registration Number:

6582152

A 3.1 Who can we Contact about your Application?

It will help us to have someone who we can contact directly with any questions about your application. The person you name should have the authority to act on behalf of the operator. This could be an agent or consultant rather than the operator.

Name: STEVE SCOTTON KARL HITCHENS
Position: H/SENIOR MANAGER FACILITIES
Address: BURNSALL ROAD
CANLEY
COVENTRY Postcode: CV5 6RT

Telephone Number: 02476 691000

Fax Number: 02476 854046

E-mail Address: SCOTTON@COUPRESS.COM
KARL.HITCHENS@COUPRESS.COM

B 1 ABOUT THE INSTALLATION

When filling in this Section please refer to Schedule 1 Part 2 of the EP Regulations (see P1 Section 2 of this form for website address)

Please fill in the table below with details of all the current activities in operation at the whole installation.

In Column 1 Box A Activities in the Stationary Technical Unit

Please identify all activities listed in Schedule 1 of the EP Regulations that are, or are proposed to be, carried out in the stationary technical unit of the installation

In Column 1 Box B Directly Associated Activities

Please identify any directly associated activities that are, or are proposed to be, carried out on the same site which:

- have a technical connection with the activities in the stationary technical unit,
- could have an effect on pollution.

In Column 2 Boxes A and B Schedule 1 References

Please quote the Chapter number, Section number, then Paragraph and Sub-paragraph number as shown in Part 2 of Schedule 1 of the EP Regulations. For example, *Manufacturing glass where the use of lead compound is involved*, would be listed as Chapter 3, Section 3.3, Part B(b).

B 1.1 Installation Table for New Permit Application

COLUMN 1	COLUMN 2
Box A - Activities in the Stationary Technical Unit	Box A - Schedule 1 References
AQUEOUS WASH & POWDER COATING APPLICATION	CHAPTER 6, SECTION 6.4 PART B AI
COLUMN 1	COLUMN 2
Box B - Directly Associated Activities	Box B - Schedule 1 References

B 1.2 Why is the Application Being Made?

- The installation is new.
- It is an existing installation but changes to the installation or to the EP Regulations means that an LAPPC Part B Permit is now required

B 1.3 Site Maps

Please provide:

- A suitable map showing the location of the installation clearly defining extent of the installations in red.

Document Reference: GENERAL LOCATION REF 0007

- A suitable plan showing the layout of activities on the site, including bulk storage of materials, waste storage areas and any external emission points to atmosphere.

Document Reference: REF 0008

B 2 THE INSTALLATION

Please provide written information about the aspects of your installation listed below. We need this information to determine whether you will operate the installation in a way in which all the environmental requirements of the EP Regulations are met.

B 2.1

Describe the proposed installation and activities and identify the foreseeable emissions to air, water and land from each stage of the process (this will include any foreseeable emissions during start up, shut down and any breakdown/abnormal operation).

The use of process flow diagrams may aid to simplify the operations.

Document Reference: 0001

B 2.2

Once all foreseeable emissions have been identified in the proposed installation activities, each emission should be characterised (including odour) and quantified.

Atmospheric emissions should be categorised under the following:

- i. Point source (e.g. chimney/vent, identified by a number and detailed on a plan). **STACKS - STEAM.**
- ii. Fugitive source (e.g. from stockpiles / storage areas).

If any monitoring has been undertaken please provide the details of emission concentrations and quantify in terms of mass emissions. If no monitoring has been undertaken please state this.

(Mass Emission - the quantification of an emission in terms of its physical mass per period of time. For example grams per hour, tonnes per year).

B 2.3

For each emission identified from the installation's activities describe the current and proposed technology and other techniques for preventing or, where that is not practicable, reducing the emissions. If no techniques are currently used and the emission goes directly to the environment without abatement or treatment, this should be stated.

Document Reference: CYCLONE'S 0003

B 2.4

Describe the proposed systems to be used in the event of unintentional releases and their consequences. This must identify, assess and minimise the environmental risks and hazards and provide a risk based assessment of any likely unintentional releases, including the use of historical evidence. If no assessments have been carried out please state.

Document Reference: NO EXT EMISSIONS - ENCLOSED WORK AREA
NO DRY SWEEPING. INDUSTRIAL VACUUM USE.

B 2.5

Describe the proposed measures for monitoring all identified emissions including any environmental monitoring and the frequency, measurement methodology and evaluation procedure proposed (e.g. particulate matter emissions, odour etc.). Include the details of any monitoring which has been carried out which has not been requested in any other part of this application. If no monitoring is proposed for an emission please state the reason.

Document Reference: 0004

B 2.6

Provide detailed procedures and policies of your proposed environmental management techniques in relation to the installation activities described.

Document Reference: ISO14001 0005

B 3 IMPACT ON THE ENVIRONMENT

B 3.1

Provide an assessment of the potential significant local environmental affects of the foreseeable emissions (for example, is there a history of complaints; is the installation in an Air Quality Management Area?).

Document Reference: No

B 3.2

Are there any sites of special scientific interest (SSSIs) or European Sites which are within either:

- 2 kilometres for an installation which includes Part B combustion, incineration (but not crematoria), iron and steel and non ferrous metal activities
- 1 kilometre for Part B mineral activities and cement and lime installations
- ½ a kilometre for all other Part B activities

No

Yes Please give names of the sites.

B 3.3

Provide an assessment of whether the installation is likely to have a significant effect on such sites and, if it is, provide an assessment of the implications of the installation for that site, for the purposes of the Conservation (Natural Habitats etc.) Regulations 1994.

Document Reference: N/A

B 4 ENVIRONMENTAL STATEMENTS

B 4.1

Has an environmental impact assessment been carried out under The Town and Country Planning (Environmental Impact Assessment) (England and Wales) Regulations 1999, or for any other reason with respect to the installation?

No

Yes Please supply a copy of the environmental impact assessment and details of any decision made.

Document Reference: N/A.

B 5 ADDITIONAL INFORMATION

Please supply any additional information which you would like us to take account of in considering this application.

Document Reference: 0006

C 1 FEES AND CHARGES

The enclosed charging scheme leaflet gives details of how to calculate the application fee. Your application cannot be processed unless the application fee is correct and enclosed.

C 1.1 Please State the Amount Enclosed as an Application Fee for this Installation

£ 1579 Cheques should be payable to: Coventry City Council

We will confirm receipt of this fee when we write to you acknowledging your application.

C 1.2

Please give any company purchase order number or other reference you wish to be used in relation to this fee.

C 2 ANNUAL CHARGES

If we grant you a permit you will be required to pay an annual subsistence charge: failure to do so will result in revocation of your permit and you will not be able to operate your installation.

C 2.1

Please provide details of the address you wish invoices to be sent to and details of someone we may contact about fees and charges within your finance section.

COUPRESS HOLDINGS LTD
BURNHALL ROAD, CANLEY
COVENTRY Postcode: CV5 6RT
Telephone Number: 02476 691000

C 3 COMMERCIAL CONFIDENTIALITY

C 3.1

Is there any information in the application that you wish to justify being kept from the public register on the grounds of commercial confidentiality?

No

Yes

Please provide full justification, considering the definition of commercial confidentiality within the EP Regulations.

Document Reference: _____

C 3.2

Is there any information in the application that you believe should be kept from the public register on the grounds of national security?

No

Yes

Do not write anything about this information on this form. Please provide full details on separate sheets, plus provide a copy of the application form to the Secretary of State for a Direction on the issue of National Security.

C 4 DATA PROTECTION

The information you give will be used by the Local Authority to process your application. It will be placed on the relevant public register and used to monitor compliance with the permit conditions. We may also use and/or disclose any of the information you give us in order to:

- Consult with the public, public bodies and other organisations.
- Carry out statistical analysis, research and development on environmental issues.
- Provide public register information to enquirers.
- Investigate possible breaches of environmental law and take any resulting action.
- Prevent breaches of environmental law.
- Assess customer service satisfaction and improve our service.
- Respond to requests for information under the Freedom of Information Act 2000 and the Environmental Information Regulations 2004 (if the Data Protection Act allows).

We may pass on the information to agents/representatives who we ask to do any of these things on our behalf.

It is an offence under Section 38 of the EP Regulations, for the purpose of obtaining a permit (for yourself or anyone else) to:

- Make a false statement which you know to be false or misleading in a material particular.
- Recklessly make a statement which is false or misleading in a material particular.

If you make a false statement we may prosecute you, and if you are convicted, you are liable to a fine or imprisonment (or both).

C 5 DECLARATION

C 5.1 Previous Offences (please delete as applicable)

I/We certify:

EITHER

* No offences have been committed in the previous five years which are relevant to my/our competence to operate this installation in accordance with the EP Regulations

OR

The following offences have been committed in the previous five years which may be relevant to my/our competence to operating this installation in accordance with the Regulations:

Signature:  _____

Name: STEVE COOTON

Position: HEALTH + SAFETY FAN MANAGER

Date: 12-10-2010

C 5.2 Signature of Current Operator(s)*

I ~~we~~ certify that the information in this application is correct. I ~~we~~ apply for a permit in respect of the particulars described in this application (including supporting documentation) I / we have supplied.

Please note that each individual operator must sign the declaration themselves, even if an agent is acting on their behalf.

For the Application from: COVENTRY COUNCIL

Installation Name: COUPRESS HOUSINGS LTD

Signature: 

Name: MIKE GILLET

Position: C.E.O.

Date: 12/10/10

Signature: _____

Name: _____

Position: _____

Date: _____

* *Where more than one person is defined as the operator, all should sign. Where a company or other body corporate - an authorised person should sign and provide evidence of authority from the board of the company or body corporate.*

Document Ref: 0001 (B2.1)

Process flow diagram

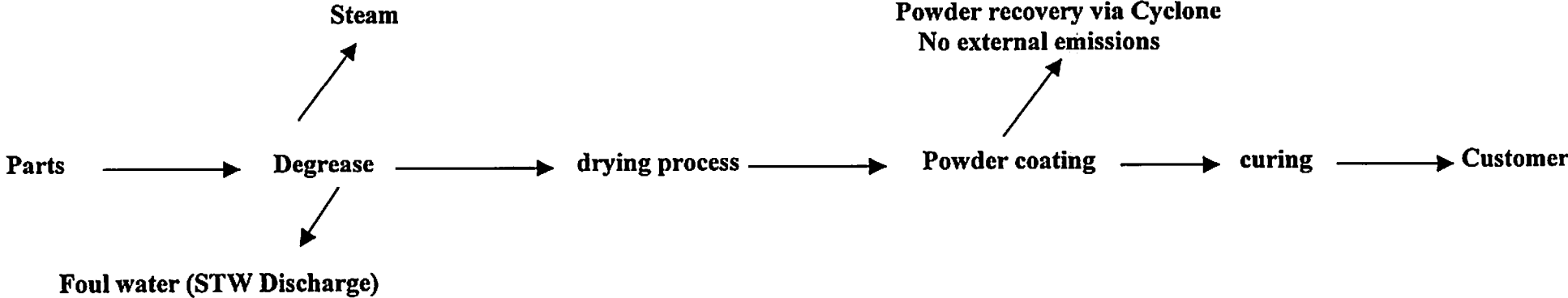

Document Ref: 0002 (B2.2)

Foreseeable emissions from process -

- I. Point Source – stacks from process emitting steam & hot air
- II. Fugitive Source – Powder coating material handling, waste handling, industrial vacuum

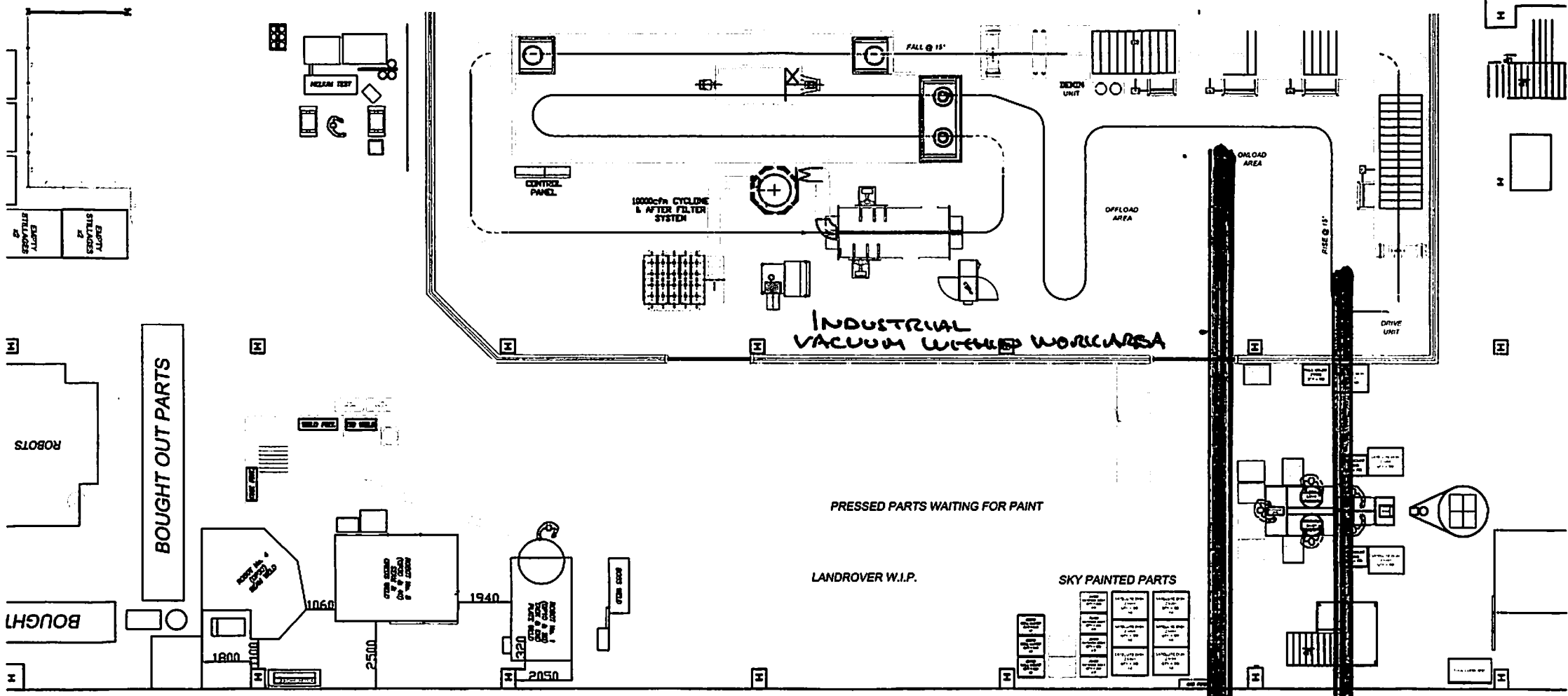

BOUGHT OUT PARTS

INDUSTRIAL VACUUM WORKSHOP

PRESSED PARTS WAITING FOR PAINT

LANDROVER W.I.P.

SKY PAINTED PARTS

STACKS
EMITTING
STEAM & HOT AIR

REPAIR STILLS
ALWAYS

ROBOTS

BOUGHT

GAS BOTTLE LOCATION

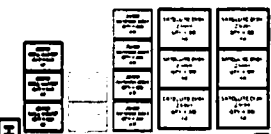
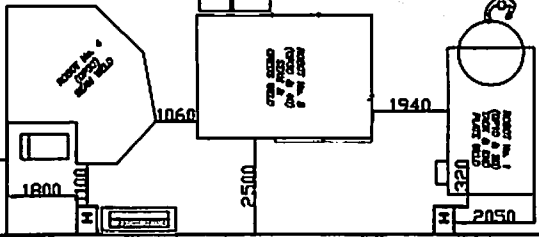

Document Ref 0003: (B 2.3)
Cyclone units (within building area)

CYCLONE UNIT

BOUGHT OUT PARTS

WELDER TEST

CONTROL PANEL

12000cph CYCLONE & AFTER FILTER SYSTEM

FALL @ 15"

BENCH UNIT

ONE LOAD AREA

OFFLOAD AREA

RISE @ 11"

DRIVE UNIT

PRESSED PARTS WAITING FOR PAINT

LANDROVER W.I.P.

SKY PAINTED PARTS

1060
CYCLONE UNIT
BY WELDER TEST
GAS 2007M

1940
CYCLONE UNIT
BY WELDER TEST
GAS 2007M

CYCLONE UNIT

SKY PAINTED PARTS
1. 10000cph Cyclone
2. 10000cph Cyclone
3. 10000cph Cyclone
4. 10000cph Cyclone
5. 10000cph Cyclone
6. 10000cph Cyclone
7. 10000cph Cyclone
8. 10000cph Cyclone
9. 10000cph Cyclone
10. 10000cph Cyclone

PAINT CABINETS

GAS 2007M

Document Ref: 0004 (B 2.5)

Proposed measures to check for emission monitoring from process

Check perimeter of building for

- Offensive odours outside boundary
- Check for emissions of particulate outside boundary

Intended checks logged on weekly basis

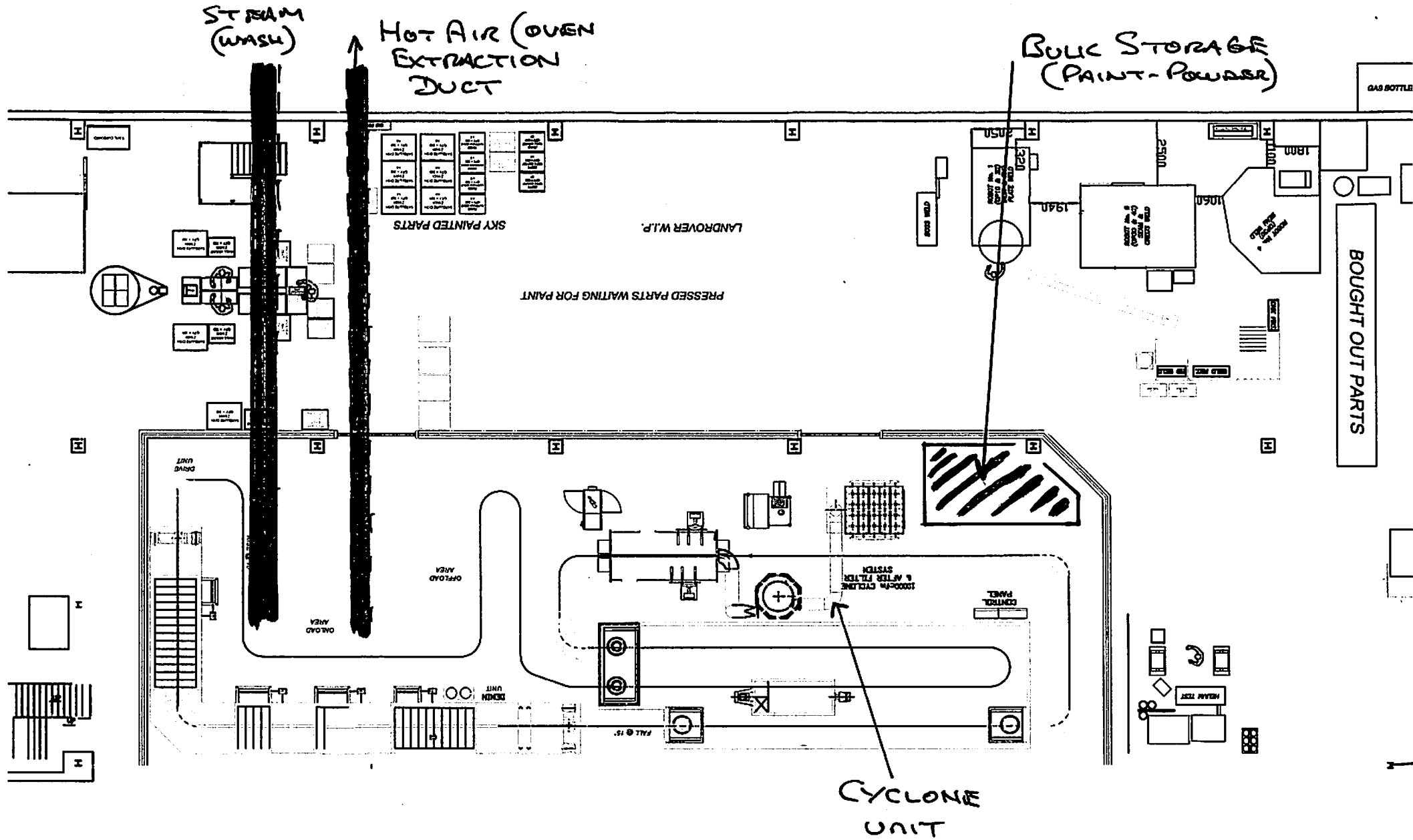

Document Ref; 0005 (B 2.6)

Copy of ISO14001 Certificate & Cert No – EMS 70164



Certificate of Registration

ENVIRONMENTAL MANAGEMENT SYSTEM - ISO 14001:2004

This is to certify that:

Covpress Holdings
Burnsall Road
Canley
Coventry
CV5 8RT
United Kingdom

Holds Certificate No. **EMS 70164**

and operates an Environmental Management System which complies with the requirements of ISO 14001:2004 for the following scope:

The manufacture of pressings and welded assemblies.

For and on behalf of BSI:

Managing Director, BSI Management Systems (UK)

Originally registered: 14/04/2003

Latest issue: 12/02/2009

Expiry Date: 12/04/2012



Page: 1 of 1

This certificate was issued electronically and remains the property of BSI and is issued by the conditions of contract. An electronic certificate can be authenticated online. Printed copies can be validated at www.bsigroup.com/ClientDirectory

The British Standards Institution is incorporated by Royal Charter. Management Systems (UK) Headquarters: F.O. Box 5000, Milton Keynes MK14 6WT. Tel: 0845 080 9000



Document Ref: 0006 (B 5)

Copy of company Environmental Policy



B - ENVIRONMENTAL POLICY

Covpress Holdings Limited is a major 1st tier engineering company located in the South West part of Coventry. The company is a supplier to the automotive industry. The Covpress Holdings Ltd site is 22 acres and bounded by the A45 London to Birmingham main rail link and a number of small manufacturing companies. The Canley Brook skirts the West Side of the site.

The Management team at Covpress Holdings Ltd recognises that all its activities, products and services have an impact on the environment. Therefore good environmental practice is vital to the survival and posture of both the company and that of its customers and suppliers alike, providing benefits in image, competitive advantage and working conditions that ensure the demands of regulations, customers, insurers, employees and the local community are met.

Our Policy towards the effective management of the environment is as follows:

◆As a minimum we will at all times comply with the latest mandatory legal requirements for all activities and processes carried out at Covpress Holdings Ltd. Through the development of an integrated Environmental Management System (EMS) we will promote the same to our employees and all suppliers and contractors performing activities on our behalf.

◆We intend as a primary objective to continually monitor our processes to minimise energy consumption and:

Where viable reduce waste through recovery and recycling of resources. Design and development activities will take into account life cycle thinking to minimise our products environmental impact during production, useful lifetime and ultimate disposal.

◆We will utilise the full potential of the workforce through training to raise awareness of environmental issues and the need for continuous improvement.

◆Functionally, on a day to day basis, we will be proactive in identifying actual or potential sources of pollution through risk analysis, plans for preventing pollution and improving performance will be prepared, communicate and implemented.

◆On an annual basis, Management will review the environmental performance of the company in order to :

- i) Ensure compliance with the requirements of legislation and this policy;
- ii) Identify areas for improvement, set specific objectives for the company and, where possible, target dates for achievement.

In addition to this policy being displayed and distributed to all our employees, copies are also available to any organisation or individuals without prejudice who make such a request.

Approved on behalf of Covpress Holdings Ltd

Managing Director

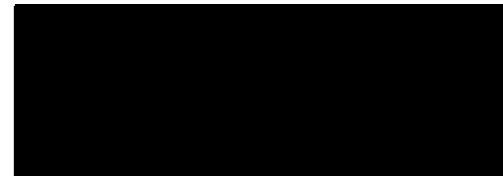

Document Ref 0007 (B1.3)

Site Map (copy google earth)



Coventry, CV56RT, UK

© 2010 Infoterra Ltd & BlueSky
© 2010 Tele Atlas
© 2010 Europa Technologies

Google

Imagery Date: Apr 14, 2007 52°23'50.06" N 1°33'11.06" W elev 97 m Eye, alt 650 m

Document ref: 0008 (B 1.3)

Plan showing Cyclones, bulk storage & emissions from plant

